



# AUDIO-GUIDE

## SOUND SYSTEMS

UK

AUS

NZ

# Audio Guide

1004450-00A / en / 06.2008

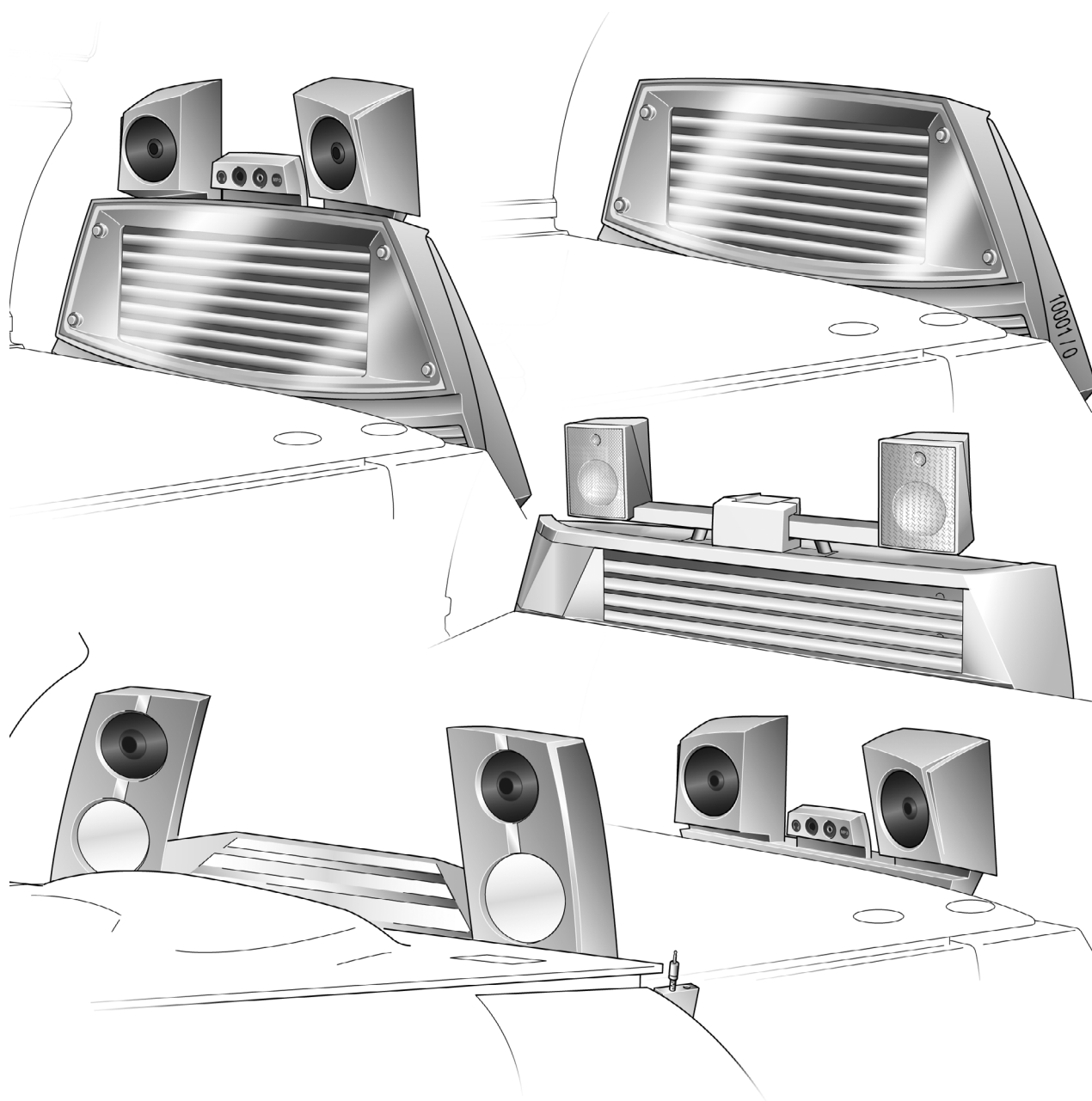

JK GLOBAL SERVICE

*Engel*

*soltron*

SUN|DASH

wellsystem™

**Dear Customer,**

This brochure will provide you with the technical requirements that will enable you to master music playback in your tanning salon.

It will give you an overview on the music and voice playback capabilities of the latest generation of sound systems, as well as a short description of the previous systems.

You will also learn all about the connection options available and the presets offered by the different systems.

Should you have any questions, please contact us and we will be happy to assist you.

Yours sincerely,  
Your JK-Global Service GmbH

**Contact address:****JK-Global Service GmbH**

Customer Service  
Rottbitzer Straße 89  
53604 Bad Honnef  
GERMANY

☎ Tel.: +49 (0) 22 24 / 818-861  
☎ Fax: +49 (0) 22 24 / 818-205  
e-mail service@jk-globalservice.de

**Note:**

Please observe the legal regulations of your country regarding the playback and use of copyright-protected music!

Unauthorized use may result in severe civil and criminal penalties which could adversely affect the company's operations.

We reserve the right to make technical changes to the illustrations and specifications in this brochure.

Reproduction of this document or parts thereof is only permitted with our previous written approval and with specification of the source.

We are not responsible for accuracy, actuality and completeness of the information provided herein. No claims of any kind will be honoured. We have no influence on the content of Internet pages referred to in this brochure. We have no influence on the function of the software products referred to in this brochure. We are not responsible for the contents of the above-mentioned external sources.

June 2008, JK-Global Service GmbH

**Safety instructions**

To ensure that listening to music continues to be an enjoyable experience for your customers, we would like to inform you about the risk of hearing loss caused by loud music.

**Risk of hearing loss**

- With time, the human ear becomes accustomed to high sound levels.
- The higher you adjust the volume, the quicker the hearing can be damaged.
- The use of ear pieces and headphones at high volume can lead to permanent hearing loss.

**Preventive measures to protect your customers**

- Always set the output volume on your sound systems and TV sets to a low level.
- Regularly check your sound systems and TV sets, the headphones and loudspeakers in all the rooms and sunbeds for interferences and background noise. Replace defective equipment and equipment parts.
- Adjust the frequencies of radio stations to eliminate any interfering background noise.

**Note:**

Please pass on this information to other personnel and instruct them accordingly.

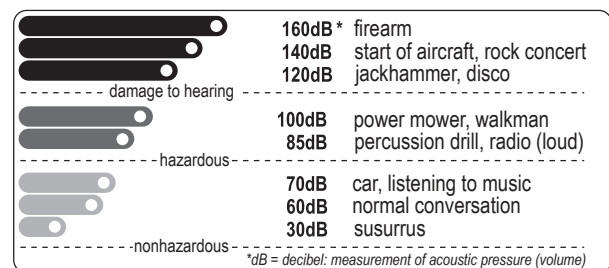
**Sound level comparison**

**Table of Contents**

<b>Safety instructions</b> .....	<b>2</b>	<b>Connection options Stereo Sound</b> .....	<b>38</b>
<b>Table of Contents</b> .....	<b>3</b>	Location of the terminal block on the units .....	39
<b>Equipment and Sound Systems as of 2006/2007</b> .....	<b>4</b>	Connection options board 12244 .....	41
<b>Description of sound systems</b> .....	<b>7</b>	Connection options board 12243 .....	43
3D sound (Power Sound) .....	7	Connection options audio bridge 12320 .....	43
User functions .....	7	Connection options of the individual audio boards .....	44
Operator functions (all models) .....	9	<b>Controls and channel selection methods</b> .....	<b>46</b>
3D sound Ergoline Prestige, Ergoline Esprit, Ergoline Sunangel S 52 .....	10	<b>Using SD cards</b> .....	<b>47</b>
3D sound Ergoline Affinity, Ergoline Sunangel S 46, Soltron M/L/XL/XXL .....	11	How to create an SD card for 3D sound .....	48
3D sound Ergoline Inspiration, Soltron S-55/S-50 .....	12	Formatting an SD card .....	48
3D sound Ergoline Open Sun 1050 .....	13	Problems with SD cards .....	49
3D sound Ergoline Open Sun Pilot .....	14	Creating MP3 files .....	50
3D sound Ergoline Sunrise, Soltron V-55/V-50 .....	15	Storing MP3 files on the SD card .....	53
Stereo Sound .....	16	Using existing MP3 files .....	56
Functions available on systems with Stereo Sound (S = standard, O = option) .....	16	<b>Checklist audio presets (3D sound)</b> .....	<b>58</b>
Hardware options (S = standard, O = option) .....	18	<b>Index</b> .....	<b>60</b>
Stereo Sound Ergoline Excellence and Evolution series .....	19		
Stereo Sound Soltron XL and M series .....	19		
Stereo Sound Ergoline Open Sun 550 .....	20		
Stereo Sound Ergoline Advantage 400 APS .....	20		
Stereo Sound Ergoline Advantage .....	21		
Stereo Sound Soltron S-45, S-40 .....	22		
Stereo Sound Ergoline Classic .....	23		
Stereo Sound Ergoline Lounge/Soltron V-60 .....	24		
Stereo Sound Vertical .....	24		
Stereo Sound Ergoline Sunrise, Soltron V-55/V-50 .....	25		
Stereo Sound Soltron V-45, Sun Dash 342 Radius .....	25		
Voice Guide and Info .....	26		
Voice Info .....	26		
Sound systems until 2006 .....	27		
Multivision .....	27		
3D sound .....	27		
Vibra-Sound .....	28		
<b>Connection options 3D sound</b> .....	<b>29</b>		
MP3 line-in .....	29		
Internal music (SD card) .....	31		
Salon's music system .....	32		
Connection options board 12962 .....	36		

## Equipment and Sound Systems as of 2006/2007

The new generation of sound systems for the Ergoline and Soltron models combines three systems into one and, in addition, allows individual configuration in the salon thanks to a wide range of possible settings.

A further new feature introduced with the latest models (Prestige, Esprit, Affinity, Inspiration, Sunangel, Open Sun 1050, Open Sun Pilot, Sunrise, XXL, XL, L, M, S and V) is 3D sound retrofitting capability. This way, you don't have to decide at the moment of purchase if you want your new unit to be fitted with or without 3D sound.

### from January 2007 3D sound

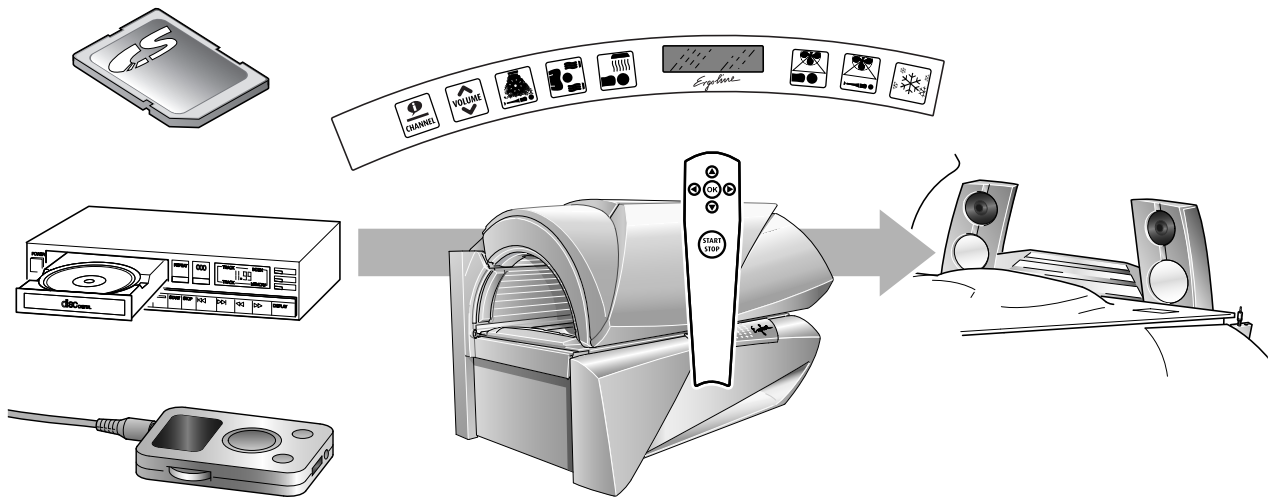

### until January 2007 Stereo Sound

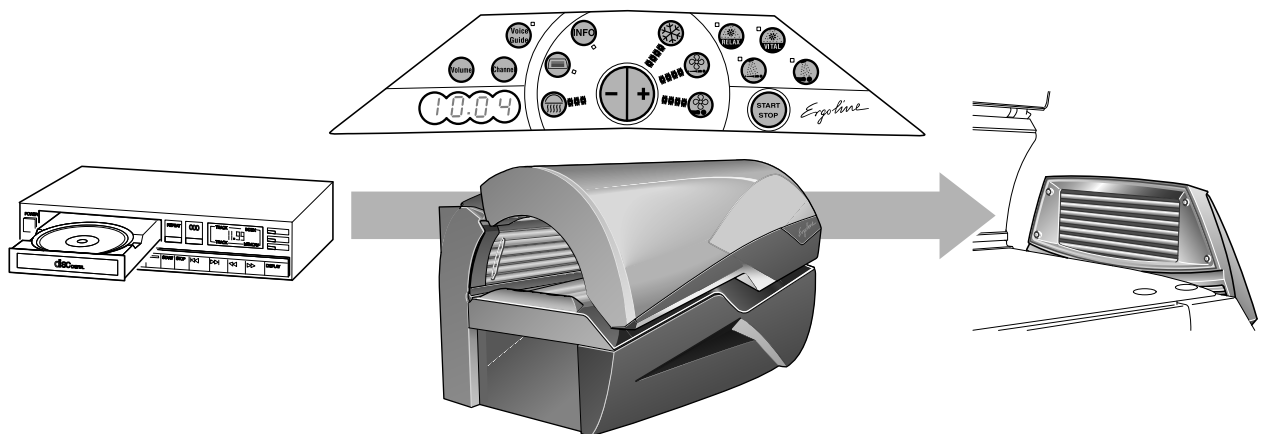

10011 / 0

**Note:**

This overview only includes the currently available sound systems. In the chapter "Description of sound systems", from page 27 onwards, you will find information on some of the sound systems offered until 2006.

Model series	3D sound <sup>1)</sup>	Stereo Sound <sup>2)</sup> (Full features)	Stereo Sound <sup>3)</sup> (Basic)	Voice Guide & Info
Ergoline Prestige	Option <sup>4)</sup>	–	–	Option
Ergoline Prestige IQ	Standard	–	–	Standard
Ergoline Prestige 1100	Standard	–	–	Standard
Ergoline Sunangel S 52	Standard	–	–	Standard
Ergoline Excellence	–	Standard	–	Standard
Ergoline Evolution	–	Standard	–	Standard
Ergoline Esprit	Option	–	–	Option
Ergoline Esprit IQ	Standard	–	–	Standard
Ergoline Affinity	Option	–	–	Option
Ergoline Affinity IQ / Affinity 950	Standard	–	–	Standard
Ergoline Sunangel S 46	Standard	–	–	Standard
Ergoline Open Sun 1050	Option	–	–	Option
Ergoline Open Sun 550	–	Standard	–	–
Ergoline Inspiration	Option	–	–	Option
Ergoline Advantage 400	–	Option	Standard	–
Ergoline Advantage 350	–	–	Standard	–
Ergoline Advantage APS	–	Standard	–	Standard
Ergoline Ambition	–	–	–	–
Ergoline Lounge	–	Option	Serie	–
Ergoline Sunrise	Option	Option	–	Option
Ergoline Vertical	–	–	Standard	Standard <sup>5)</sup>
Ergoline Classic 200/300	–	Option <sup>6)</sup>	Option <sup>6)</sup>	–
Ergoline Open Sun Pilot	Standard	–	–	Standard
Ergoline Classic 8000	–	–	–	–

1) The 3D sound systems of the different model series can be distinguished by their individual appearance and functions (see chapter "Description of sound systems" page 7 ff.). Available from Soltron under the designation "Power Sound".

2) Stereo Sound is available in different equipment options, see page 16 ff. Stereo Sound with full features: Audio board amplifier 12244

3) Stereo Sound Basic: Audio bridge 12320, audio board 12243 or individual board, all with limited range of functions

4) Option: Equipment option with surcharge

5) Ergoline Vertical is equipped with Voice Info, see page 26.

6) Stereo Sound for Classic 200 and 300 differs from the other Stereo Sound systems. See page 23.

Model series	3D sound <sup>1)</sup>	Stereo Sound <sup>2)</sup> (Full features)	Stereo Sound <sup>3)</sup> (Basic)	Voice Guide & Info
Soltron XXL-95	Standard	–	–	–
Soltron XL-75/L-65/M-60	Option	–	–	–
Soltron XL-70/M-55/M-50	–	Option	Standard	–
Soltron S-55	Option	–	–	–
Soltron S-50	Option	–	–	–
Soltron S-45	–	Option	Standard	–
Soltron S-40	–	–	Standard	–
Soltron XS-35	–	–	–	–
Soltron V-60	–	Option	Standard	–
Soltron V-55	Option	Option	–	–
Soltron V-50	Option	Option	–	–
Soltron V-45	–	–	Option	–
Sun Dash 342 Radius	–	–	Option	–

1) The 3D sound systems of the different model series can be distinguished by their individual appearance and functions (see chapter "Description of sound systems" page 7 ff.). Available from Soltron under the designation "Power Sound".

2) Stereo Sound is available in different equipment options, see page 16 ff. Stereo Sound with full features: Audio board amplifier 12244

3) Stereo Sound Basic: Audio bridge 12320, audio board 12243 or individual board, all with limited range of functions

## Description of sound systems

### 3D sound (Power Sound)

The designation “3D sound” covers the sound systems of several of the latest sound systems. The systems share the same design and connectivity features but differ in the individual operating comfort. The new generation 3D sound systems include an integral audio unit which enables music reproduction with or without connection to the salon’s music system.

3D sound features the playback options **Studio music channel**, **Music selection** and **Own music**.

**Studio music channel:** As with all sound systems supplied with the Ergoline and Soltron tanning systems, they can be connected to the salon’s music system.

**Music selection:** Music reproduction is now possible independently from the salon’s music system, and in a very simple manner: All you need to do is insert a rewritable music SD card.

**Own music:** Users wanting to listen to their own music through the 3D sound system can do so by simply connecting to it their own MP3 player, portable CD player or similar.

In the Ergoline models, 3D sound is supplied with Voice Guide and Info as standard. All the latest tanning systems with sensor technology come with 3D sound as standard.

If you are planning to retrofit your system with 3D sound, please contact the Customer Service.



**Note:**

In previous Ergoline and Soltron systems, the salon’s music system was connected internally at the foot of the tanning unit. In the current 3D sound systems, the salon’s music system is connected to the sound box at the head of the tanning unit.

For salons with fixed wiring, we offer a ready-to-use extension which provides a bridge between the foot and the head ends of the unit (see chapter “*Connection options 3D sound*” on page 29 ff.).

### User functions

Available function <sup>1)</sup>	Prestige	Sunangel S 52	Esprit	Affinity	Sunangel S 46	Inspiration	Open Sun 1050	Open Sun Pilot	Sunrise
Voice Guide/Info	Standard	Standard	Standard	Standard	Standard	Standard	Standard	Standard	Standard
<b>NEW:</b> MP3-connection (Line-in)	Standard	Standard	Standard	Standard	Standard	Standard	Standard	Standard	Standard
Headphone connection <sup>2)</sup>	Standard	Standard	Standard	Standard	Standard	Standard	Standard	Standard	Standard
Integrated music card <b>NEW:</b> (depending on tanning system)	Standard	Standard	Standard	Standard	Standard	Standard	Standard	Standard	Standard
Choice of music source	Standard	Standard	Standard	Standard	Standard	Standard	Standard	Standard	Standard
<b>NEW:</b> Title selection (MP3/internal SD card)	Standard	Standard	Standard	Standard	Standard	Standard	Standard	Standard	Standard
<b>NEW:</b> Text display of music title (internal SD card only)	Standard	Standard	Standard	–	–	–	Standard	Standard	–
Volume control	Standard	Standard	Standard	Standard	Standard	Standard	Standard	Standard	Standard

1) For systems equipped with 3D sound/Power Sound.

2) The headphone can only be used during the tanning session. The loudspeakers are always active in standby mode.



Available function <sup>1)</sup>	XXL / XL / L / M	S-55/S-50	V-55/V-50
Voice Guide/Info	–	–	–
<b>NEW:</b> MP3-connection (Line-in)	Standard	Standard	Standard
Headphone connection <sup>2)</sup>	Standard	Standard	Standard
<b>NEW:</b> Integrated music card (depending on tanning system)	Standard	Standard	Standard
Choice of music source	Standard	Standard	Standard
<b>NEW:</b> Title selection (MP3/internal SD card)	Standard	Standard	Standard
<b>NEW:</b> Text display of music title (internal SD card only)	–	–	–
Volume control	Standard	Standard	Standard

1) For systems equipped with 3D sound/Power Sound.

2) The headphone can only be used during the tanning session. The loudspeakers are always active in standby mode.

**Operator functions (all models)**

The following functions can be adjusted on the tanning unit in the preset mode. A template with a list of audio presets can be found on page 58. You can make a copy of this template for each tanning unit and use it to enter the individual settings.



**Beware! Possible risk of hearing loss!**

Very loud music can result in hearing damage.

- Set the volume for the different sources to a similar level and not too high.

Available function <sup>1)</sup>	applies to all model series
<b>NEW:</b> Music in standby mode	Music playback is also possible even when the tanning unit is not in use.
<b>NEW:</b> Random track selector	The random track selector ensures that for each tanning session, a different music track is played back from the internal SD sound card. The user can select any other track or an alternative music source at any time.
<b>NEW:</b> Internal music card	The internal music SD card (music selection) offers the salon operator the possibility to provide each individual tanning unit with a selected range of music titles. The tanning unit does not need to be connected to the salon's music system.
<b>NEW:</b> Free combination of audio sources	The 3 possible audio sources (studio music channels, line-in, music SD card) can be activated/deactivated in all combinations.
Maximum volume	Adjustment of the maximum volume for studio music channels, line-in connection (MP3, etc.) and internal music SD card.
Initial volume at the start of the tanning session	Adjustment of the initial volume at the start of the tanning session.
<b>NEW:</b> Standby volume (loudspeakers)	Adjustment of the volume for standby mode.
<b>NEW:</b> Adjustment of treble and bass	Treble and bass can be adjusted separately.
Adjustment of audio signal and channel selection	Adaptation to the connection of the salon's music system (input signal and channel selection method).
<b>NEW:</b> Setting the music sources	Selection and setting of music source (e.g. own music or music selection) for tanning start and standby mode.
Setting of external channels	Specification of the number of studio music channels.

1) An overview of all the presets is available in the document "Presets", Ergoline models: Order No. 1001971, Soltron units: Order No. 1003844

### 3D sound Ergoline Prestige, Ergoline Esprit, Ergoline Sunangel S 52

For the model series Prestige and Esprit and the Sunangel S 52, the shoulder tanner is supplied with the 3D sound unit as a standard. For the model series Prestige and Esprit, an IQ sensor can be integrated as an option. It is possible to retrofit the 3D sound system.

1. High pressure units
2. Loudspeakers (tweeter, midrange)
3. MP3 cable
4. Headphone socket
5. IQ sensor  
Option for Prestige/Esprit  
Supplied with Sunangel S 52
6. Voice Guide SD card
7. Music SD card
8. Audio unit (board) with connector for an external music system (connector can be re-ordered, part no. 13003)
9. Subwoofer

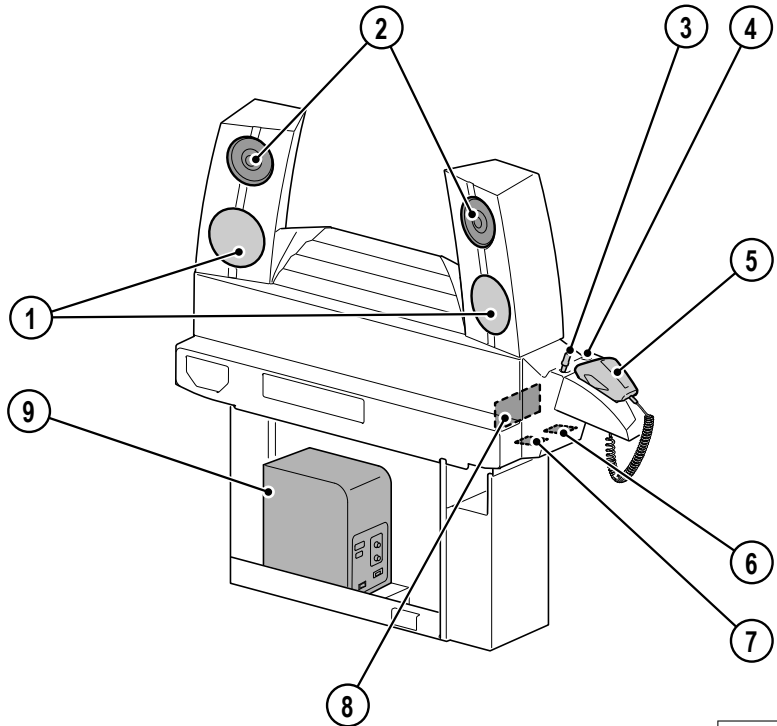

40035 / 0

**The retrofit kit includes:**

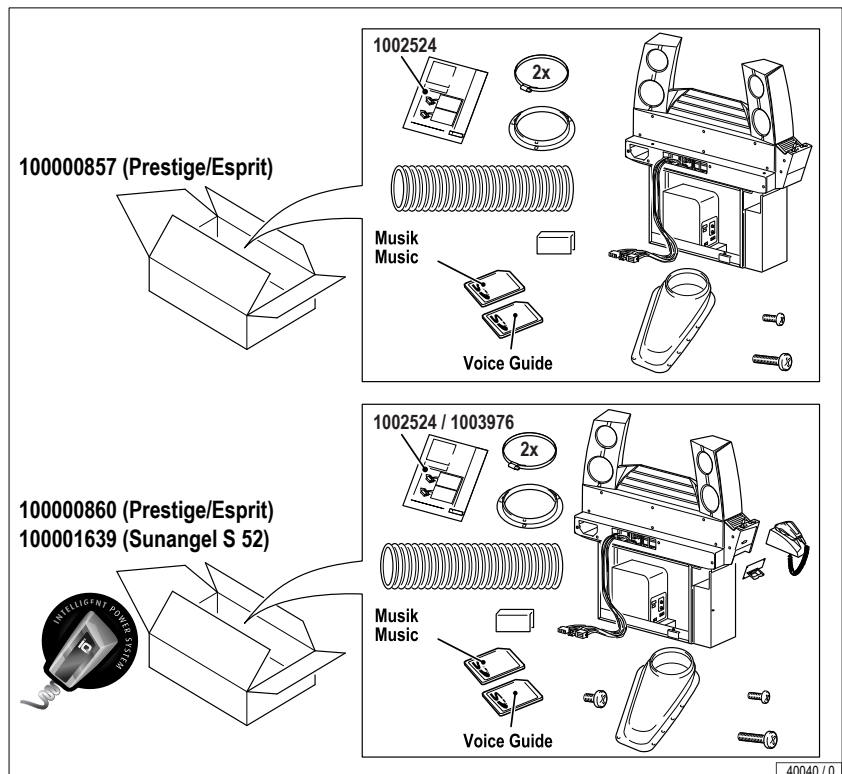

40040 / 0

**3D sound Ergoline Affinity, Ergoline Sunangel S 46, Soltron M/L/XL/XXL**

The 3D sound unit for the Affinity series and the Soltron series XXL/XL/L and M can be combined with a shoulder tanner. For the Sunangel S 46, the shoulder tanner is supplied with the 3D sound unit as a standard. Both options (with and without shoulder tanner) are available as retrofit kit.

1. Shoulder tanner
2. Loudspeakers
3. MP3 connection
4. Headphone socket
5. Music SD card
6. Voice Guide SD card<sup>1)</sup>
7. Audio unit (board) with connector for an external music system (connector can be re-ordered, part no. 13003)
8. Subwoofer

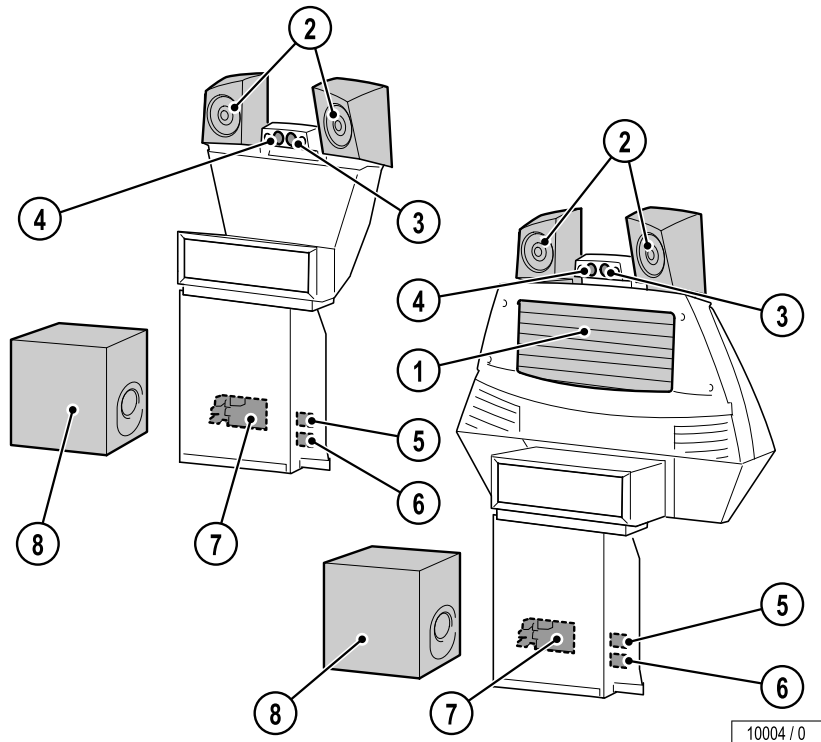

10004 / 0

**The retrofit kit includes:<sup>1)</sup>**

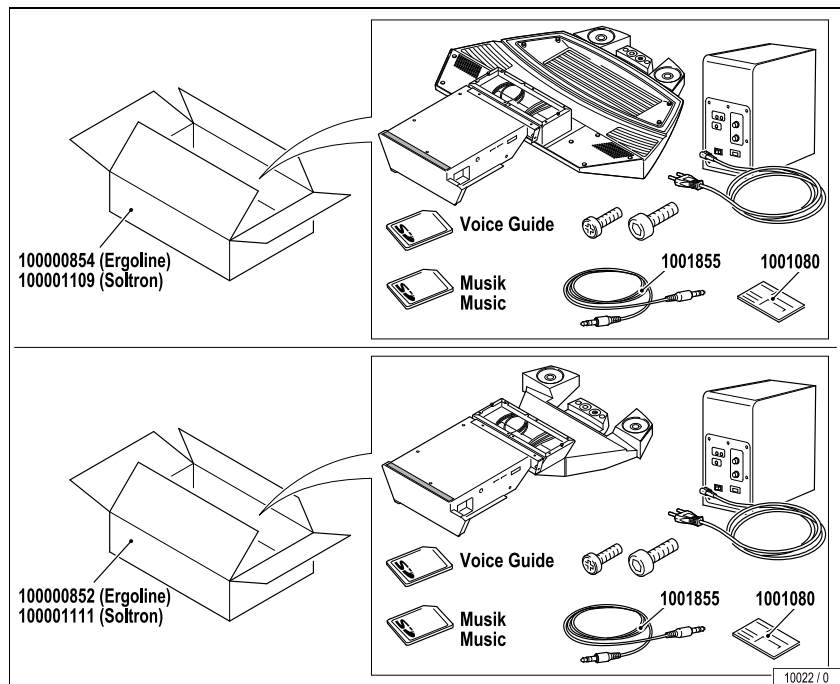

10022 / 0

1) The Voice Guide SD card is only supplied with Ergoline systems

### 3D sound Ergoline Inspiration, Soltron S-55/S-50

For the Inspiration series and the Soltron S-55/S-50 the 3D sound unit is only available without shoulder tanner. It is possible to retrofit the 3D sound system.

1. Loudspeakers
2. MP3 connection
3. Headphone socket
4. Music SD card
5. Voice Guide SD card<sup>1)</sup>
6. Audio unit (board) with connector for an external music system (connector can be re-ordered, part no. 13003)
7. Subwoofer

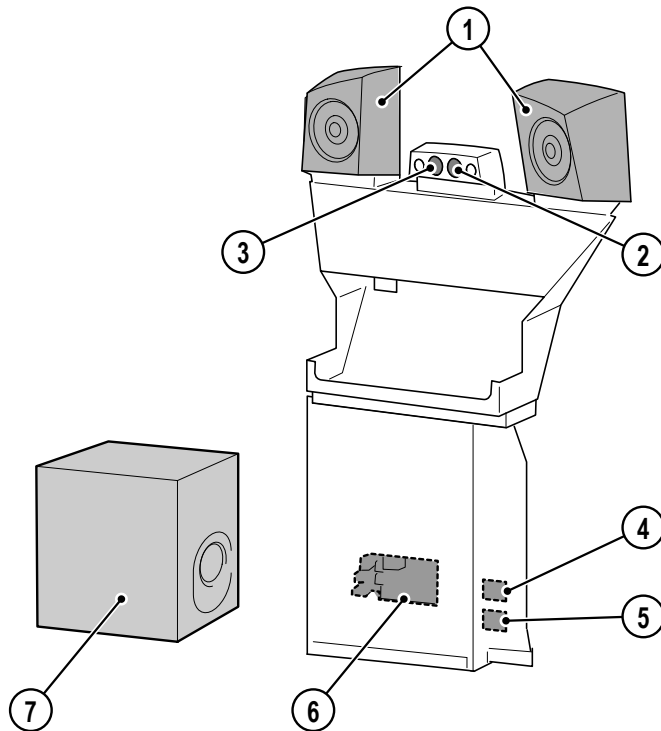

40029 / 0

#### The retrofit kit includes:<sup>1)</sup>

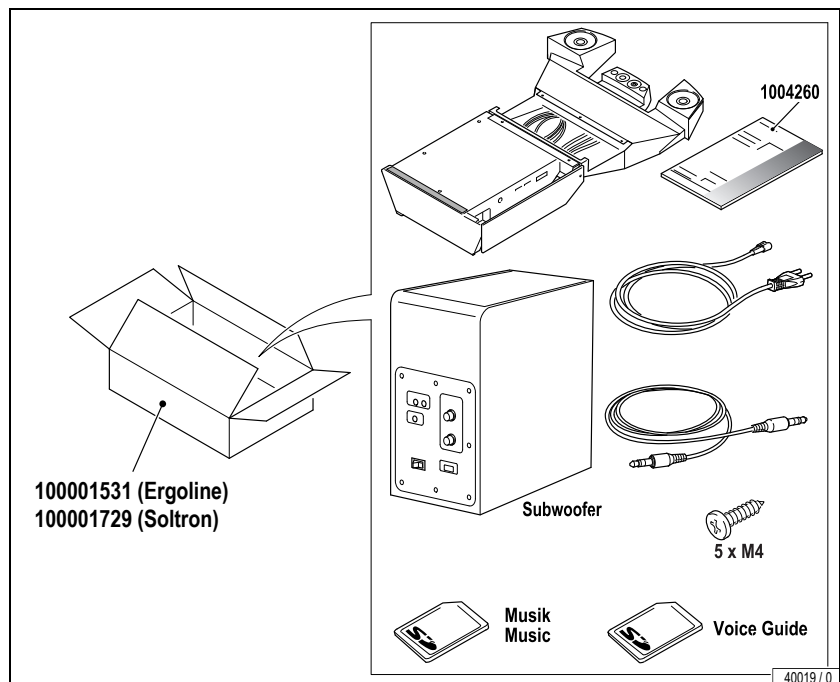

40019 / 0

1) The Voice Guide SD card is only supplied with Ergoline systems

### 3D sound Ergoline Open Sun 1050

For the Open Sun 1050 the 3D sound unit is only available without shoulder tanner. It is possible to retrofit the 3D sound system.

1. Loudspeakers
2. MP3 connection
3. Headphone socket
4. Audio unit (board) with connector for an external music system (connector can be re-ordered, part no. 13003)
5. Music SD card
6. Voice Guide SD card
7. Subwoofer

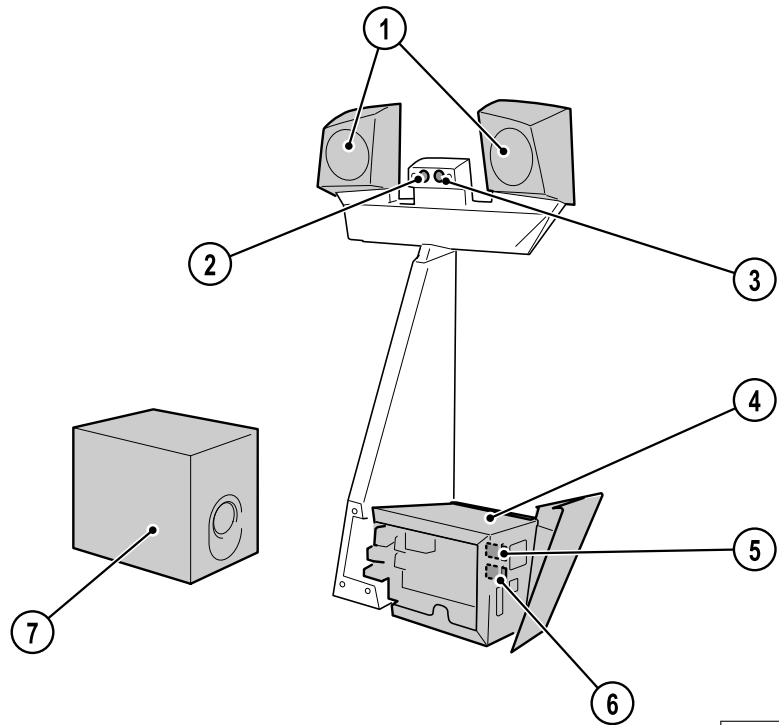

10003 / 0

**The retrofit kit includes:**

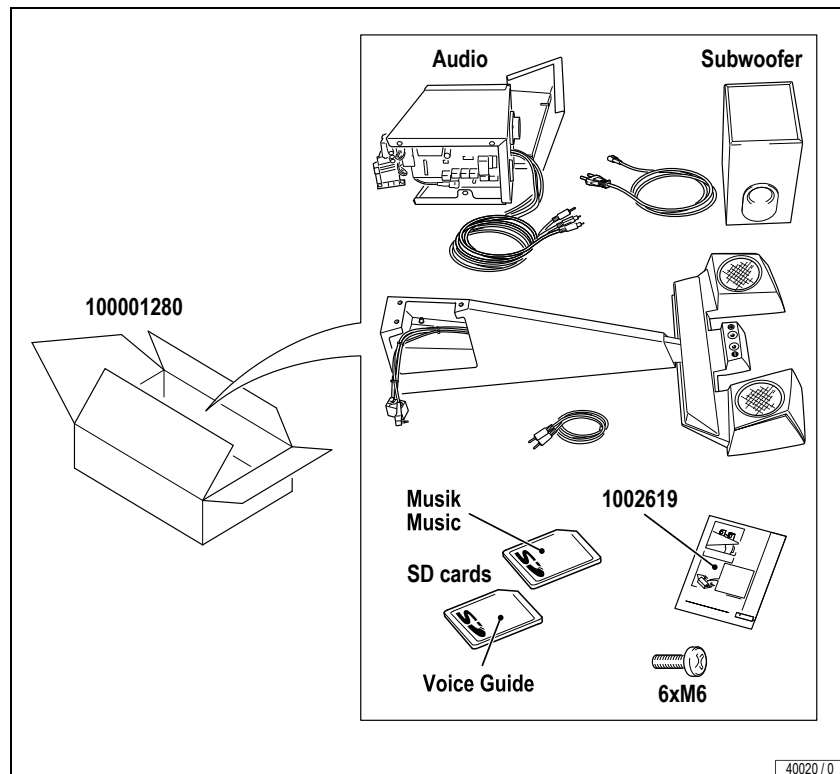

40020 / 0

### 3D sound Ergoline Open Sun Pilot

For the Open Sun Pilot the 3D sound unit is only available without shoulder tanner. It is possible to retrofit the 3D sound system.

1. Loudspeakers
2. MP3 connection
3. Headphone socket
4. Audio unit (board) with connector for an external music system (connector can be re-ordered, part no. 13003)
5. Music SD card
6. Voice Guide SD card
7. Subwoofer

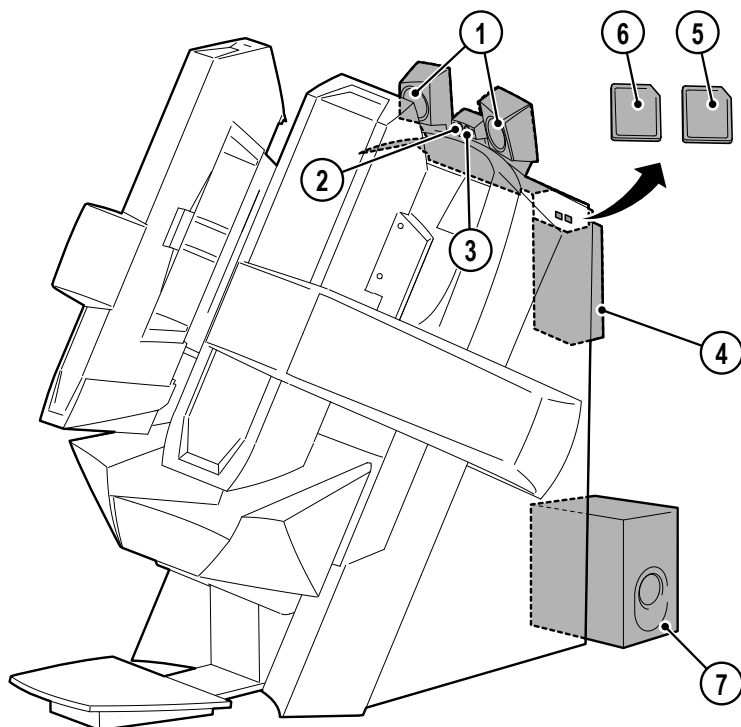

40028 / 0

The retrofit kit includes:

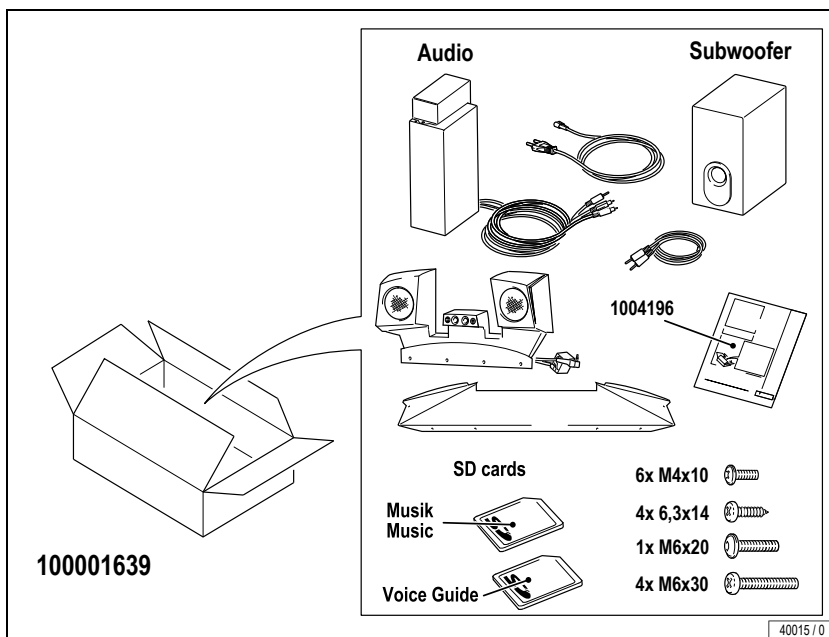

40015 / 0

### 3D sound Ergoline Sunrise, Soltron V-55/V-50

For the Sunrise series and the Soltron V-55/V-50 the 3D sound unit is only available without shoulder tanner. It is possible to retrofit the 3D sound system.

1. Loudspeakers
2. MP3 connection
3. Headphone socket
4. Audio unit (board) with connector for an external music system (connector can be re-ordered, part no. 13003)
5. Music SD card
6. Voice Guide SD card
7. Subwoofer

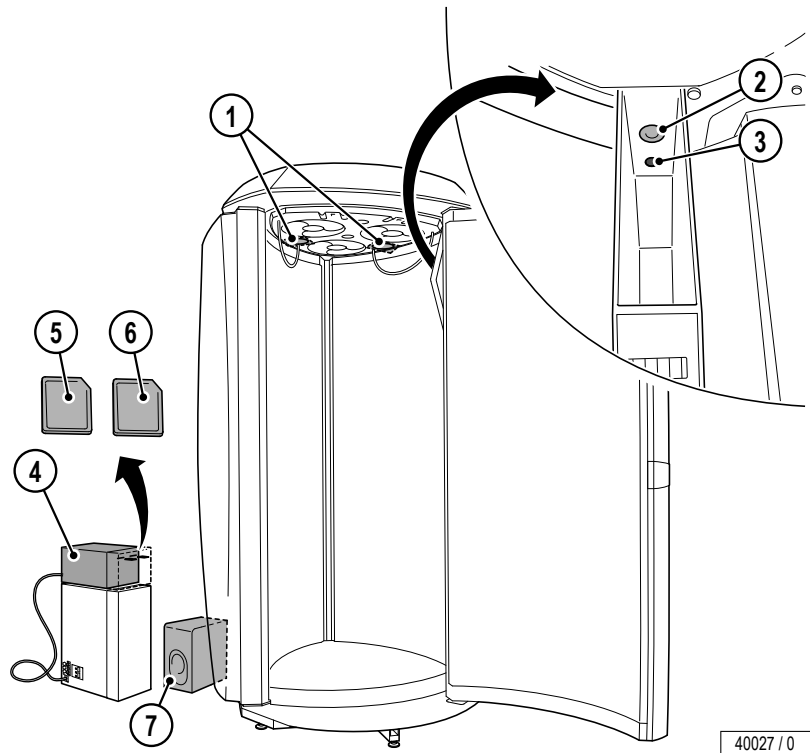

40027 / 0

The retrofit kit includes:<sup>1)</sup>

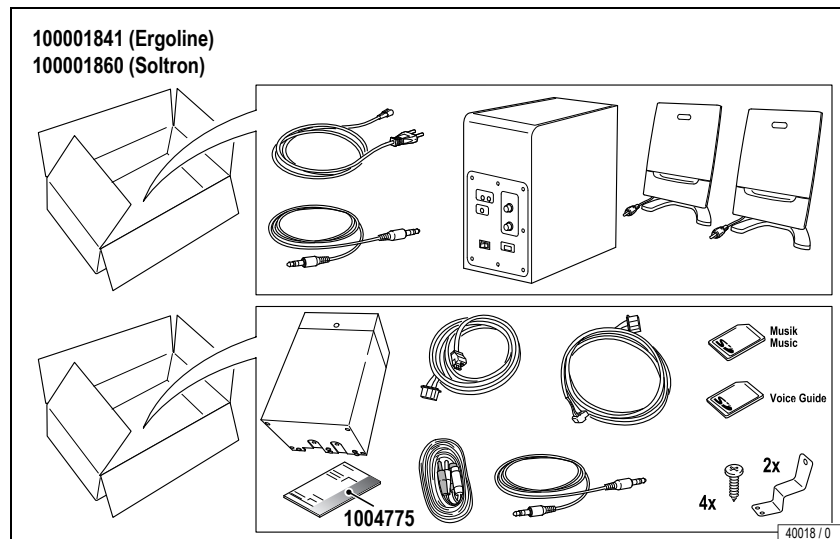

40018 / 0

1) The Voice Guide SD card is only supplied with Ergoline systems



## Stereo Sound

There are several Stereo Sound variants offering different levels of operating comfort, among others. The basic option is a headphone connection without volume control, while the most sophisticated option includes a headphone connection and loudspeakers, as well as volume control and channel selection.

The headphone connection is in the tanning unit. The loudspeakers are either in the unit or in the shoulder tanner.

Systems equipped with Stereo Sound have no internal music playback capability and must be connected to an external music source (CD player, radio, salon's music system).

If you are planning to retrofit your system with Stereo Sound, please contact the Customer Service.

### Functions available on systems with Stereo Sound (S = standard, O = option)

	Excellence	Evolution	Open Sun 550	Advantage 400 APS	Advantage 400	Advantage 350	Classic 200/300	Lounge	Sunrise	Vertical
<b>User functions</b>										
Voice Guide/Info	S	S	-	S	-	-	-	-	-	-
Voice Info	-	-	-	-	-	-	-	-	-	S
Loudspeakers	S	S	-	S	S	S	O	-	O	-
Headphone connection	S	S	S	S	S	S	-	S	S	S
Channel selection	S	S	O	S	O	-	O	-	-	-
Volume control	S	S	S	S	O	-	O	O	S	O
<b>Operator functions (access to presets without Palm)</b>										
Music volume adjustment	S	S	S	S	S	-	-	S	S	S
Voice Guide and Info volume adjustment	S	S	S	S	S	-	-	-	-	-
<b>Operator (access to presets with Palm) / Customer service functions (access with service PC)</b>										
Connection of external music (1 channel)	S	S	S	S	O	-	-	S	O <sup>1)</sup>	-
Connection of external music (channel selection)	S	S	S	S	O	-	-	O	-	-
Initial volume at the start of the tanning session (separate for voice and external music)	S	S	S	S	S	S	-	S	O <sup>1)</sup>	-
<b>Music pre-amplification:</b>										
Matching of music signal and voice sound levels	S	S	S	S	S	S	-	S	O <sup>1)</sup>	-
Base level volume	S	S	S	S	S	S	-	S	O <sup>1)</sup>	S
Channel selection: Setting the number of external channels connected	S	S	S	S	S	S	-	S	-	-
Input signal: Selection: pre-amplifier, power amplifier, 100 V system	S	S	S	S	S	S	-	S	O <sup>2)</sup>	-
Channel selection method: switch-over between decimal, BCD or pulse	S	S	S	S	S	S	-	S	-	-

1) customer service only

2) without 100 V system

	XL-70/M-55	M-55	S-45	S-40	V-60	V-55/V-50	V-45	342 Radius
<b>User functions</b>								
Voice Guide/Info	-	-	-	-	-	-	-	-
Voice Info	-	-	-	-	-	-	-	-
Loudspeakers	S	S	S	S	-	O	O	O
Headphone connection	S	S	S	S	S	S	-	-
Channel selection	O	O	O	-	-	-	-	-
Volume control	S	S	O	-	O	S	O	O
<b>Operator functions (access to presets without Palm)</b>								
Music volume adjustment	S	S	S	-	S	S	S	S
Voice Guide and Info volume adjustment	-	-	-	-	-	-	-	-
<b>Operator (access to presets with Palm) / Customer service functions (access with service PC)</b>								
Connection of external music (1 channel)	O	S	O	-	S	O <sup>1)</sup>	-	-
Connection of external music (channel selection)	O	S	O	-	O	-	-	-
Initial volume at the start of the tuning session (separate for voice and external music)	S	S	S	S	S	O <sup>1)</sup>	-	-
Music pre-amplification: Matching of music signal and voice sound levels	S	S	S	S	S	O <sup>1)</sup>	-	-
Base level volume	S	S	S	S	S	O <sup>1)</sup>	-	-
Channel selection: Setting the number of external channels connected	S	S	S	S	S	-	-	-
Input signal: Selection: pre-amplifier, power amplifier, 100 V system	S	S	S	S	S	O <sup>2)</sup>	-	-
Channel selection method: switch-over between decimal, BCD or pulse	S	S	S	S	S	-	-	-

1) customer service only

2) without 100 V system

## Hardware options (S = standard, O = option)

Component	Excellence	Evolution	Open Sun 550	Advantage 400 APS	Advantage 400	Advantage 350	Classic 200/300	Lounge	Sunrise	Vertical
Audio bridge 12320	-	-	-	-	S	-	-	-	-	-
Volume control board 12243	-	-	-	-	O	-	-	S	-	-
Individual sound board	-	-	-	-	-	-	-	-	O	S
Audio board amplifier 12244	S	S	S	S	O	-	-	O	-	-
Voice Guide board (12642)	S	S	-	S	-	-	-	S	-	S <sup>1)</sup>
Headphone connection	S	S	S	S	S	S	-	S	S	-
Loudspeakers in unit	S	S	S	S	S	S	-	O	O	S
Loudspeakers in shoulder tanner	O	O	-	-	-	-	-	-	-	-
Loudspeakers in fan housing	O	O	-	-	-	-	O	-	-	-
Infrared interface (access to preset mode via Palm)	S	S	S	S	S	S	-	S	-	-

1) Voice Info only

Component	XL-70/M-55	M-50	S-45	S-40	V-60	V-50/V-55	V-45	342 Radius
Audio bridge 12320	-	-	S	-	-	-	-	-
Volume control board 12243	S	S	O	-	S	-	-	-
Individual sound board	-	-	-	-	-	O	O	O
Audio board amplifier 12244	O	O	O	-	O	-	-	-
Voice Guide board (12642)	-	-	-	-	-	-	-	-
Headphone connection	S	S	S	S	S	S	-	-
Loudspeakers in unit	S	S	O	O	O	O	O	O
Loudspeakers in shoulder tanner	O	O	-	-	-	-	-	-
Loudspeakers in fan housing	O	O	-	-	-	-	-	-
Infrared interface (access to preset mode via Palm)	S	S	S	S	S	-	-	-

### Stereo Sound Ergoline Excellence and Evolution series

**Standard:** Sound system with audio board for connection to an external music source, 1 channel or channel selection (see page 42 ff.). Volume and channel can be selected on the unit's control panel.

Voice Guide and Info are supplied as standard.

**Option:** On the abovementioned systems, Stereo Sound can be combined with a shoulder tanner. If a shoulder tanner is available, the loudspeakers are installed in the unit.

#### Standard equipment - functions and components:

- Audio board 12244
- Voice Guide board 12642
- Loudspeakers
- Headphone connection
- External music connection (1 channel or channel selection)
- Volume control (Volume), channel selection (Channel), Voice Guide and Info

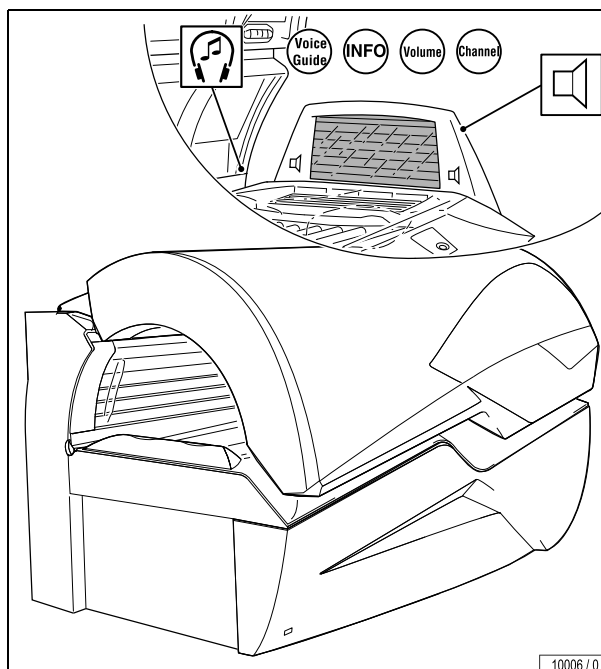

### Stereo Sound Soltron XL and M series

**Standard:** Sound system with audio board for volume control and connection of a power amplifier (1 channel). The volume can be adjusted on the control panel.

**Option:** Audio kit. Sound system with audio board for connection to an external music source with channel selection (see page 42 ff.). Volume and channel can be selected on the unit's control panel.

For the abovementioned systems, Stereo Sound can be combined with a shoulder tanner. If a shoulder tanner is available, the loudspeakers are installed in the unit.

#### Standard equipment - functions and components:

- Audio board 12243
- Loudspeakers
- Headphone connection
- Volume adjustment (Volume)
- Connection option for power amplifier 5 V to 30 V (1 channel)

#### Audio kit - functions and components (additional):

- Audio board 12244 (replaces audio board 12243)
- Channel selection (Channel)

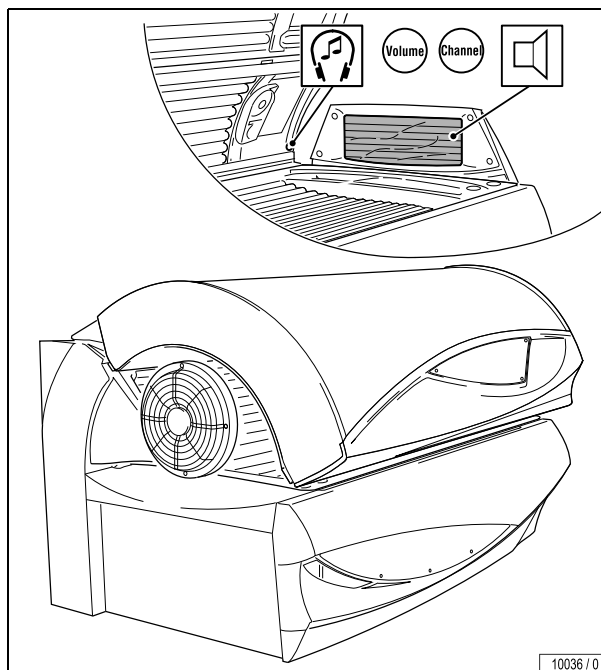

### Stereo Sound Ergoline Open Sun 550

**Standard:** Sound system with audio board for connection to an external music source, 1 channel or channel selection (see page 42 ff.). Volume and channel can be selected on the unit's control panel.

**Option:** No optional equipment available.

Stereo Sound Open Sun 550 can not be combined with a shoulder tanner.

Voice Guide and Info functions are not available.

#### Standard equipment - functions and components:

- Audio board 12244
- Loudspeakers
- Headphone connection
- External music connection (1 channel or channel selection)
- Volume control (Volume) and channel selection (Channel)

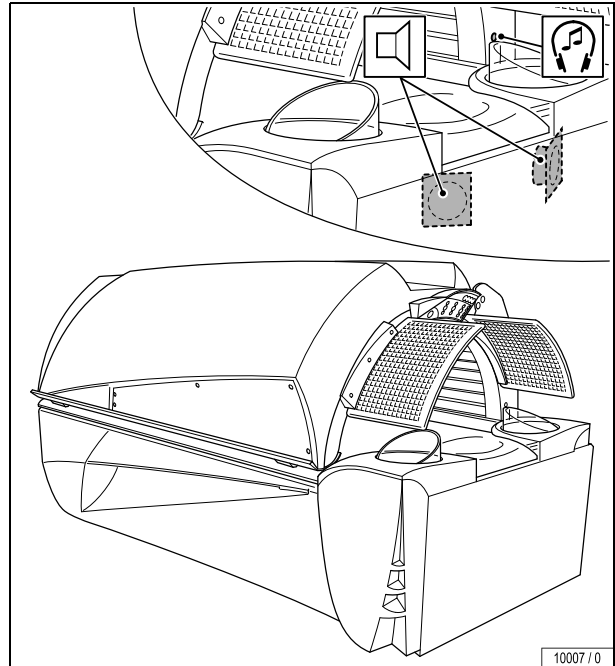

### Stereo Sound Ergoline Advantage 400 APS

**Standard:** Sound system with audio board for connection to an external music source, 1 channel or channel selection (see page 42 ff.). Volume and channel can be selected on the unit's control panel.

Stereo Sound Advantage APS can not be combined with a shoulder tanner.

**Option:** No optional equipment available.

#### Standard equipment - functions and components:

- Audio board 12244
- Voice Guide board 12642
- Loudspeakers
- Headphone connection
- External music connection (1 channel or multi-channel)
- Volume control (Volume), channel selection (Channel), Voice Guide and Info

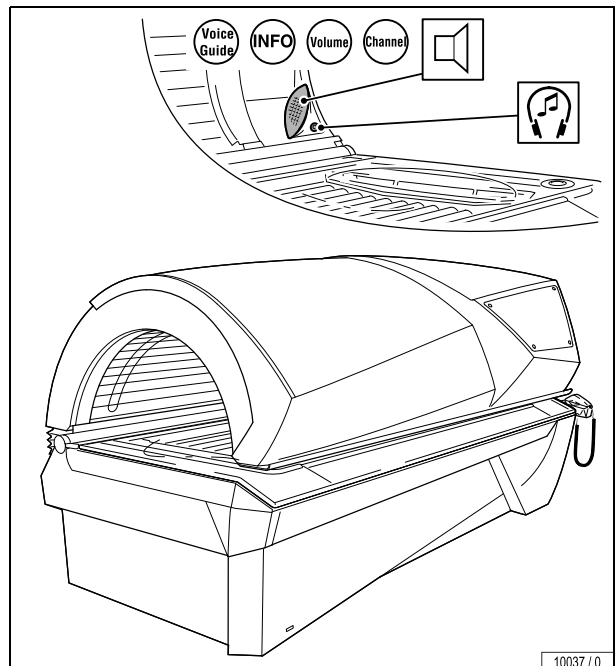

## Stereo Sound Ergoline Advantage

### Advantage 400

**Standard:** Sound system with audio bridge for direct connection of a music playback device. No volume control and channel selection possible.

**Option 1:** The audio bridge is replaced by an audio board for volume control and connection of a power amplifier (1 channel). The volume can be adjusted on the control panel.

**Option 2:** Audio kit. The audio bridge is replaced by an audio board for connection to an external music source; 1-channel or multi-channel connection is possible (see page 42 ff.). Volume and channel can be selected on the unit's control panel.

Voice Guide and Info and combination with a shoulder tanner are not possible.

#### Standard equipment - functions and components:

- Audio bridge 12320
- Loudspeakers
- Headphone connection

#### Option 1 - functions and components (additional):

- Audio board 12243 (replaces audio board 12320)
- Connection option for power amplifier 5 V to 30 V (1 channel)
- Volume adjustment (Volume)

#### Option 2 - functions and components 2 (additional):

- Audio board 12244 (replaces audio bridge 12320 or audio board 12243)
- External music connection (1 channel or channel selection)
- Channel selection (Channel)

### Advantage 350

**Standard:** Headphone connection and loudspeakers incorporated in unit, music input possible. No volume control and channel selection possible.

**Option:** No optional equipment available.

#### Standard equipment - functions and components:

- Loudspeakers
- Headphone connection
- Terminal block

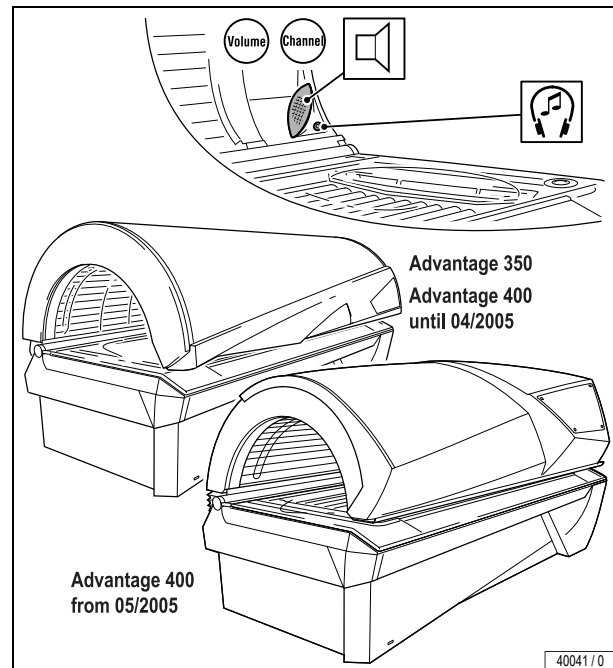

**Stereo Sound Soltron S-45, S-40****S-45**

**Standard:** Sound system with audio bridge for direct connection of a music playback device (headphones only). No volume control and channel selection possible.

**Option 1:** Loudspeaker set for the canopy.

**Option 2:** Audio kit. The audio bridge is replaced by an audio board for connection to an external music source; 1-channel or multi-channel connection is possible (see page 42 ff.). Volume and channel can be selected on the unit's control panel.

Combination with a shoulder tanner is not possible.

**Standard equipment - functions and components:**

- Audio bridge 12320
- Headphone connection

**Option 1 - functions and components (additional):**

- 2 loudspeakers

**Audio kit - functions and components (additional):**

- Audio board 12244 (replaces audio board 12320)
- External music connection (1 channel or channel selection)
- Volume control (Volume) and channel selection (Channel)

**S-40**

**Standard:** Headphone connection incorporated in unit, music input possible. No volume control and channel selection possible.

**Option:** Loudspeaker set for the canopy.

**Standard equipment - functions and components:**

- Headphone connection
- Terminal block

**Option - functions and components (additional):**

- 2 loudspeakers

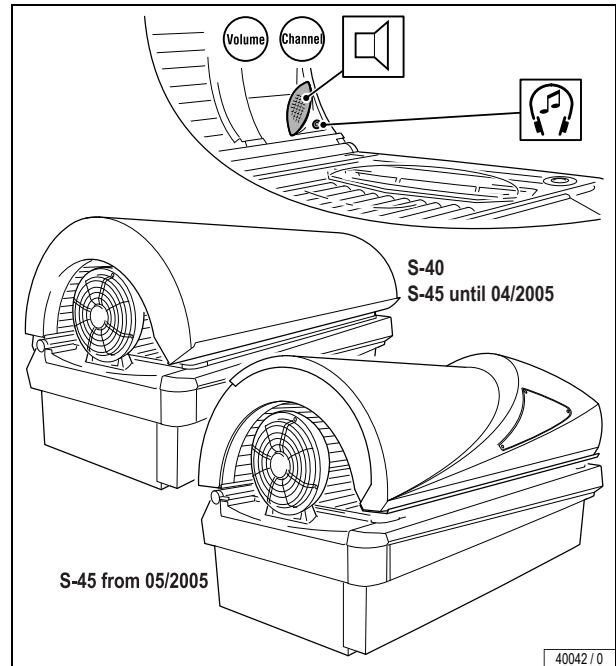

## Stereo Sound Ergoline Classic

### Classic 200/300

**Standard:** No music playback is available as a standard.

**Option 1:** Loudspeaker set for body fan housing.

**Option 2:** When using an Ergoline music system, with the help of an additional module it is possible to connect a remote control unit to adjust the volume and select different channels.

Voice Guide and Info functions are not available.

### Standard equipment - functions and components:

–

### Option 1 - functions and components:

2 loudspeakers

### Option 2 - functions and components:

Please contact your Service Partner or call JK-Global Service directly.

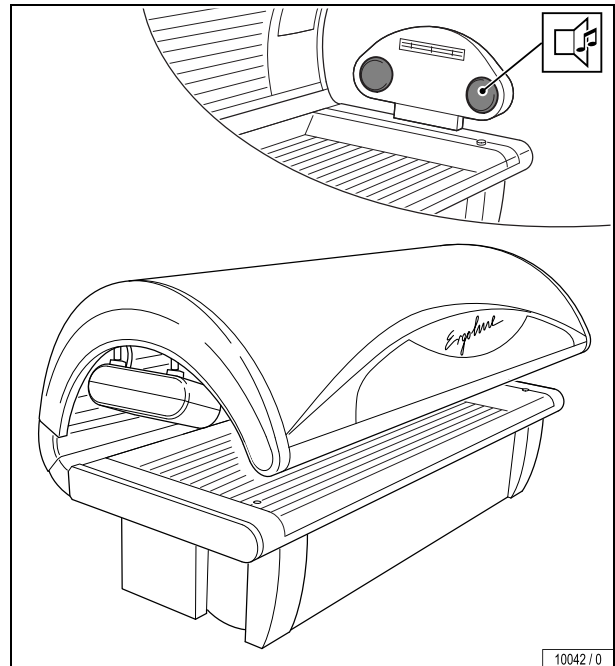



### Stereo Sound Ergoline Lounge/Soltron V-60

**Standard:** Sound system with audio board for volume control and connection of a power amplifier (1 channel). The volume for the headphone connection can be adjusted on the control panel. Loudspeakers are not included.

**Option 1:** Loudspeaker set. Music playback selectable via loudspeakers or headphones; no channel selection.

**Option 2:** Audio kit. Sound system with audio board for connection to an external music source with channel selection (see page 42 ff.). Volume and channel can be selected on the unit's control panel.

#### Standard equipment - functions and components:

- Audio board 12243
- Headphone connection
- Volume adjustment (Volume)
- Connection option for power amplifier (1 channel)

#### Option 1 - functions and components (additional)

Part no.: 34528600:

- Loudspeaker set

#### Option 2 - functions and components (additional)

Part no.: 34527200:

- Audio board 12244 (replaces audio board 12243)
- External music connection (1 channel or multi-channel)
- Channel selection (Channel)

### Stereo Sound Vertical

**Standard:** Sound system with audio board and Voice Info (see page 26). A playback device is connected to two Cinch connectors on the outside of the tanning unit.

Two loudspeakers are incorporated in the tanning unit. The volume can be adjusted on the control panel.

Voice Info is available for simple voice support.

**Option:** No optional equipment available.

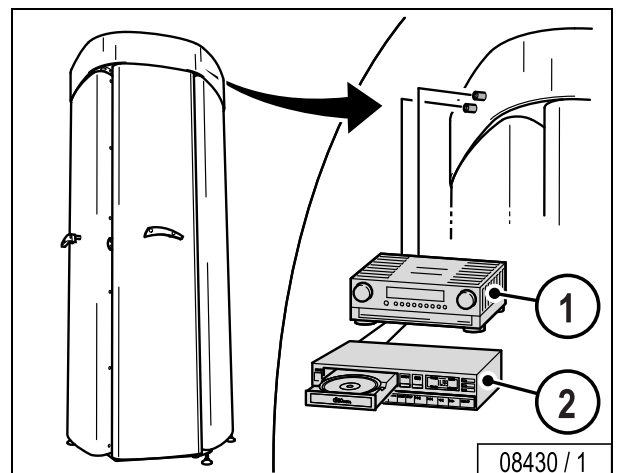
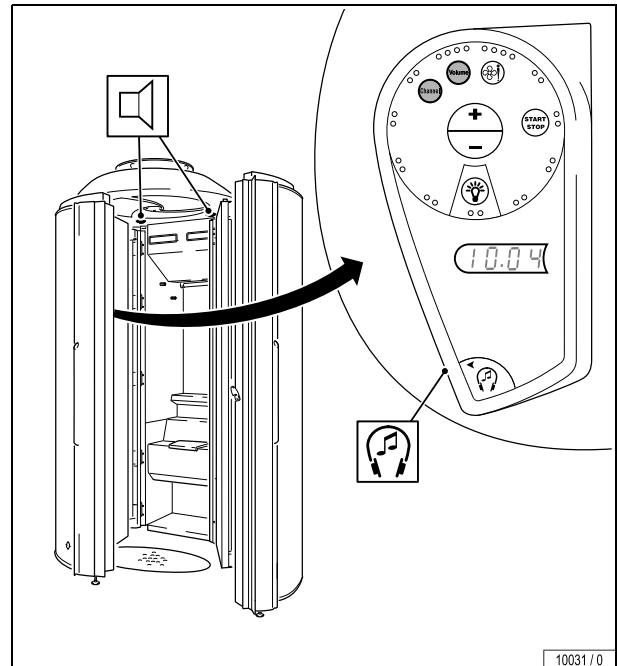

**Stereo Sound Ergoline Sunrise, Soltron V-55/V-50**

**Standard:** No music playback is available as a standard. The device is already equipped with a headphone jack.

**Option:** Audio kit: Sound system with audio board for connection to an external music source without channel selection and with loudspeaker set. Music playback selectable via loudspeakers or headphones.

The user can adjust the music volume on the unit's control panel.

**Standard equipment - functions and components:**

Headphone connection

**Option - functions and components:**

- Loudspeaker set
- Audio board

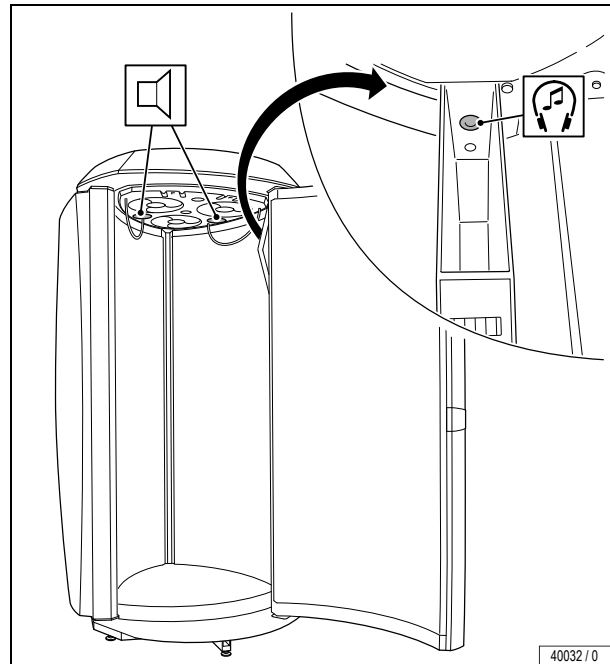

**Stereo Sound Soltron V-45, Sun Dash 342 Radius**

**Standard:** No music playback is available as a standard.

**Option 1:** The units incorporate two loudspeakers with connection means for an external audio source (3.5 mm stereo jacks).

No volume adjustment possible on the control panel.

**Option 2:** In addition to the two loudspeakers, it is possible to install a music system comprising two audio boards and a transformer. For the Soltron V-45 Mango Tango and the Sun Dash 342 Radius, external audio sources are connected via a 3.5 mm stereo jack. The Soltron V-45 Coconut Shaker is connected via the X3 clamp in the upper part.

The user can adjust the music volume on the unit's control panel.

**Standard equipment - functions and components:**

–

**Option 1 - functions and components:**

Loudspeaker set

**Option 2: functions and components (additional):**

- Power supply board
- Transformer
- Audio board

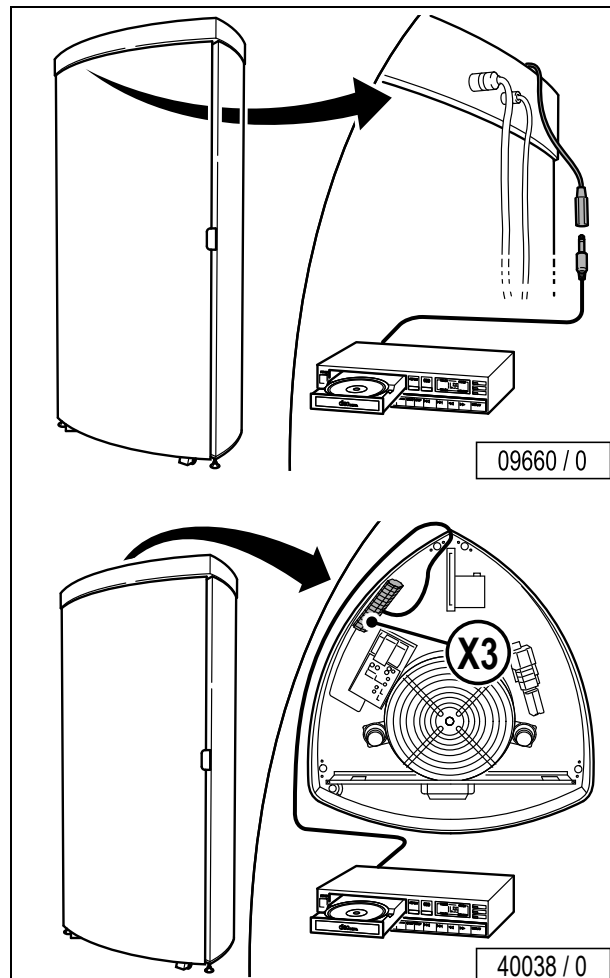

## Voice Guide and Info

Voice Guide is currently only available with the Ergoline systems equipped with 3D sound. Voice Guide provides the user and salon staff with contextual help in voice form; it informs the user in every situation about the operating step being carried out at the time.

All units equipped with base tan and skin type measuring sensors are equipped with Voice Guide as a standard to provide the user with optimal support when using the sensor. The Voice Guide is activated automatically with every new tanning session, but it can also be muted.

### SD card: Voice Guide and Info

In the current systems with integrated sound box, the texts used for voice reproduction are stored in an SD card in all the languages available. When installing the unit, the Customer Service engineer sets the desired output language.

The Info texts are also stored in this SD card. The user can obtain general tanning information by activating the Info function.

### Board: Voice Guide and Info

Evolution, Excellence and Advantage APS feature a built-in Voice Guide board. The output language can only be changed by installing a different board.

## Voice Info

Voice Info is a simple voice information system for the use of the Ergoline Vertical: Begin and end of the tanning session are announced. The half-time of the tanning session is also announced when the Vertical unit is operated without coins for a fixed tanning time (15 minutes).

## Sound systems until 2006

### Multivision

Multivision is a combination of the previous 3D sound system with a TV set. Depending on the salon's setup, the user can watch videos (music clips, adverts) or TV programmes during the tanning session.

The screen image is projected directly in front of the user's eyes via special glasses.

Further information on Multivision can be found in the operating instructions "Multivision/3D sound", order no. 801503, and in the "Investor Guide", which can be downloaded from [www.ergoline.de](http://www.ergoline.de).

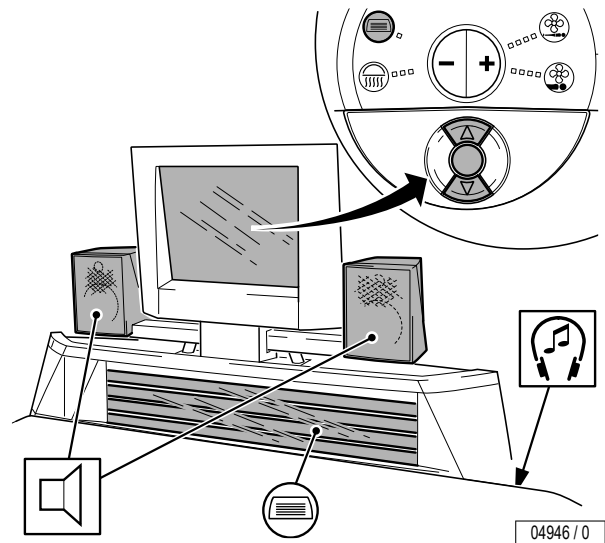
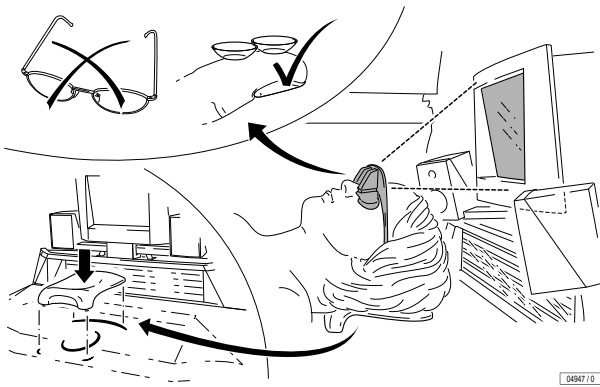

### 3D sound

The first 3D sound system became available on Evolution and Excellence models. This 3D sound system requires connection to an external playback device or to the salon's sound system.

1. Shoulder tanner
2. Headphone connection
3. Loudspeakers

Detailed information on the first 3D sound system can be found in the operating instructions "Multivision/3D sound", order no. 801503.

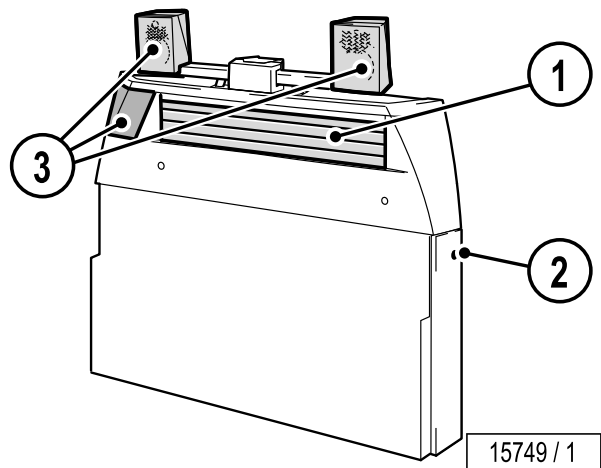

### Vibra-Sound

Vibra-Sound is a variant of Stereo Sound, which incorporates a planar diaphragm loudspeaker that is integrated in the shoulder tanner glass pane. On each side there are two tweeters (① right, ② left) and two woofers (③ right, ④ left). As with Stereo Sound, the salon's music system is connected to the audio board in the tanning unit via a terminal block.

The Vibra flat speaker is characterised by the uniform sound distribution and higher acoustic power due to its wider acoustic emission characteristics. These features ensure a particularly high quality of speech reproduction. In addition, Vibra-Sound offers the same usage options as Stereo Sound.

Vibra-Sound was only available for the models Ergoline Excellence and Ergoline Evolution.

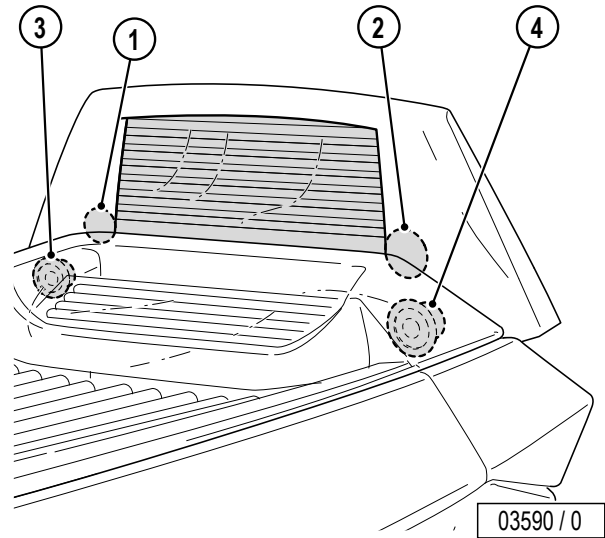

## Connection options 3D sound

All units incorporating the latest 3D sound system offer the same connection options:

- MP3 line-in (see below)
- Internal music (SD card) (see page 31)
- Salon's music system (see page 32 ff.)

### MP3 line-in

Salon customers can connect their own MP3 player (or any other device with a line-in jack e.g. a radio, a portable CD player or a walkman) to the 3D sound box and listen to the music via the loudspeakers or headphones.

The connection cable for the MP3 player is part of the scope of supply of the 3D sound system. The Prestige, Esprit and Sunangel S 52 have an integrated connection cable. In case of the Affinity, Inspiration und Sunrise series, Sunangel S 46, Open Sun 1050, Open Sun Pilot and the Soltron series, the cable is supplied as a separate item and is provided to salon customers on request for each tanning session.



**Note:**

Fees are payable for the public reproduction of music titles. Please observe the legal requirements in your country.

If you only enable the MP3 connection on a tanning unit (see "Presets", Ergoline systems: order no. 1001971, Soltron units: order no. 1003844), you are offering your customers the possibility to listening to their own music and in this case no public reproduction of music will take place.

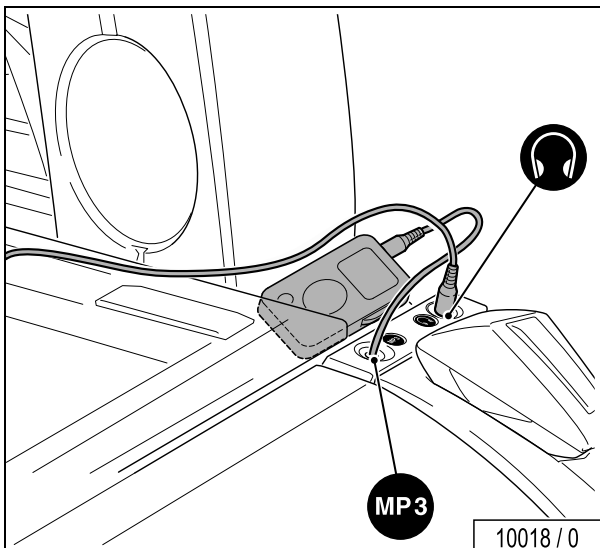

Connection options for Prestige and Esprit devices and Sunangel S 52

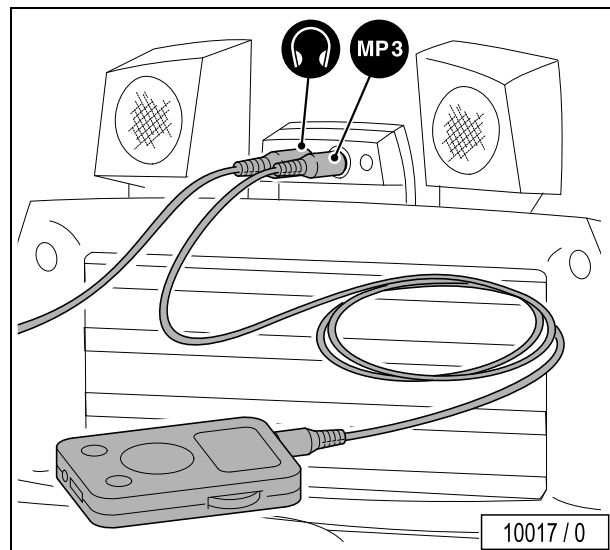

Connection options for Affinity devices, Sunangel S 46, and Soltron XXL-95, XL-75, L-65 and M-60

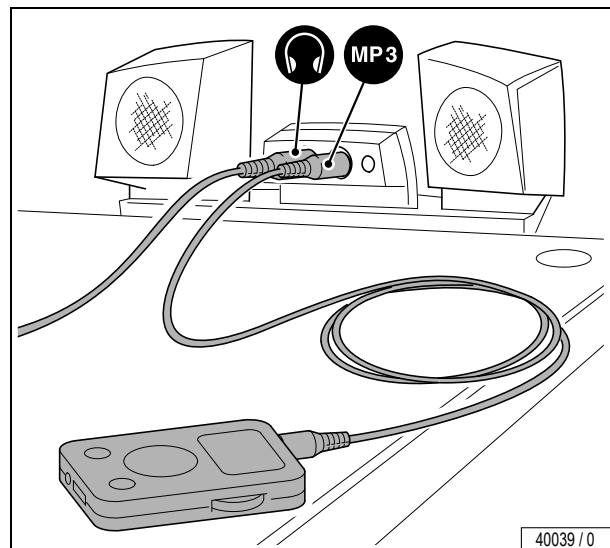

Connection options for Affinity and Inspiration devices and Soltron XXL-95, XL-75, L-65, M-60, S-55 and S-50

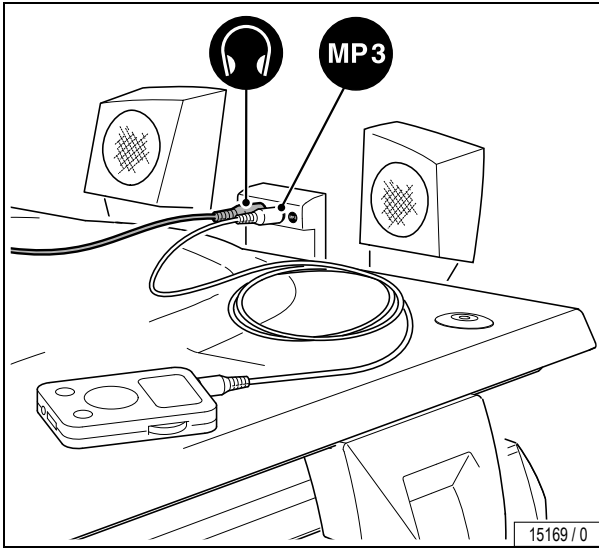

Connection options for Open Sun 1050

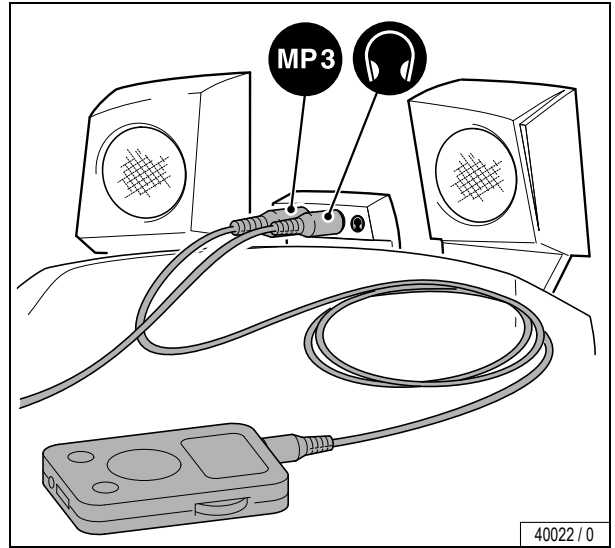

Connection options for Open Sun Pilot

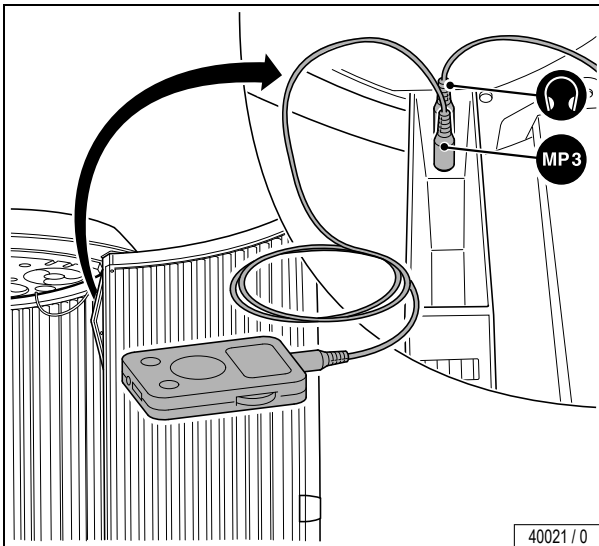

Connection options for Sunrise devices and Soltron V-55 and V-50

## Internal music (SD card)

In all the systems, the 3D sound box incorporates two SD card slots. One slot is reserved for Voice Guide and Info, the second slot can be used for an SD card containing a personal music compilation or an SD card containing license-free music<sup>1)</sup> and which can be obtained directly from Ergoline.



**Note:**

The system can only read MP3 data. Other formats, e.g. iTunes files are unsuitable.

For the music titles to appear in text format on the display, the MP3 files must be stored with ID3 tags. If the tags are not available, then the titles will only be displayed with the running number (01, 02, ...).

On page 47 and following, you will find further information on the MP3 data format and on recording music on an SD card.

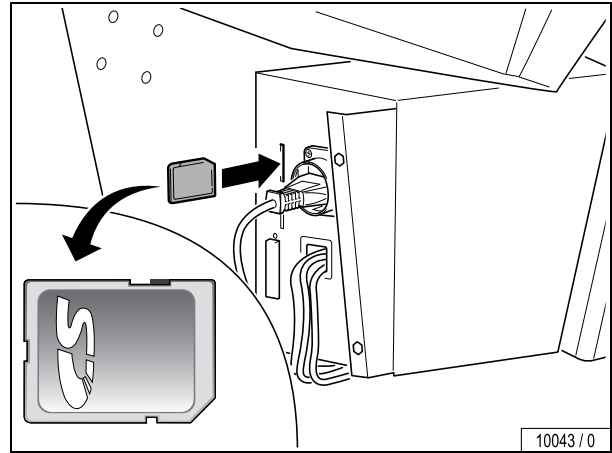

Location of the internal music SD card in Open Sun 1050

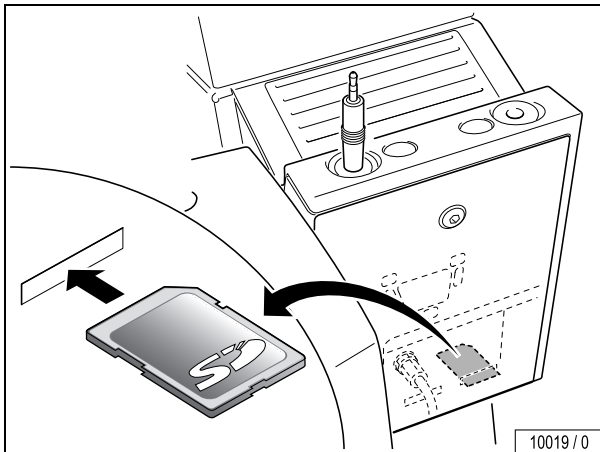

Location of the internal music SD card in Prestige and Esprit devices, Sunangel S 52

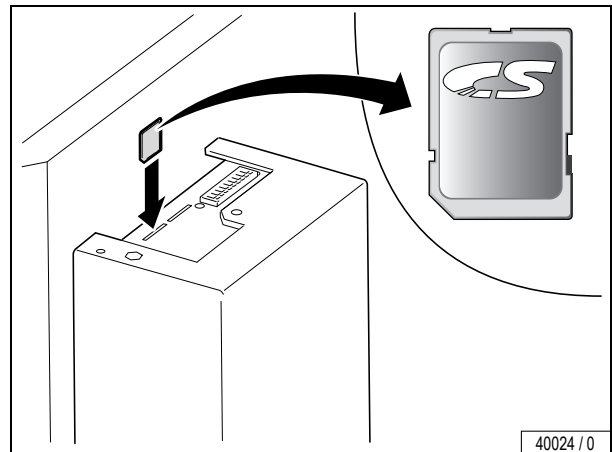

Location of the internal music SD card in Open Sun Pilot

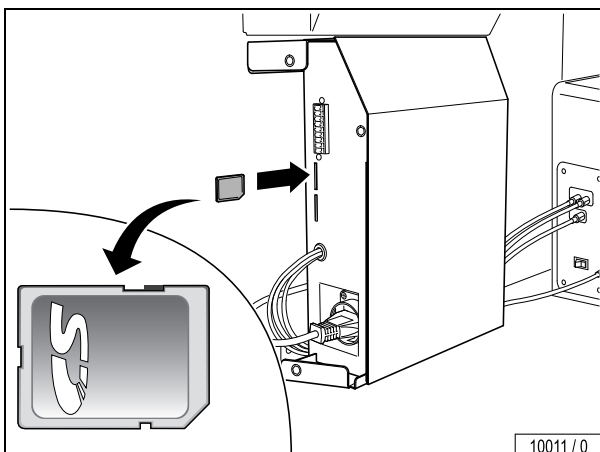

Location of the internal music SD card in Affinity and Inspiration devices, Sunangel S 46 and Soltron XXL-95, XL-75, L-65, M-60, S-55 and S-50

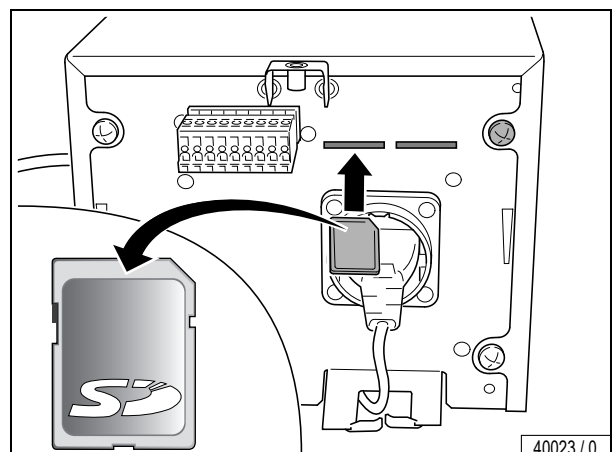

Location of the internal music SD card in Sunrise devices and Soltron V-55 and V-50

1) The Ergoline music card contains music titles, the reproduction of which is not subjected to payment of fees.



## Salon's music system



**Note:**

In the new model series, the salon's music system is no longer connected to the rear at the foot of the unit, but rather at the head of the tanning unit (socket in sound box). If you are changing from an older model to a new series model, you can obtain a cable set which will allow you to continue using the salon's existing connections.

Audio cable set (without channel selection):  
500000161

Audio cable set (with channel selection):  
500000160

Depending on the music control software, there are up to 16 audio channels available.

500000160

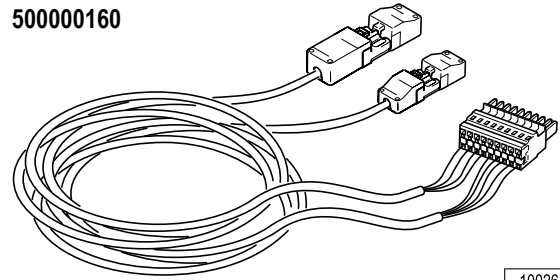

10026 / 0

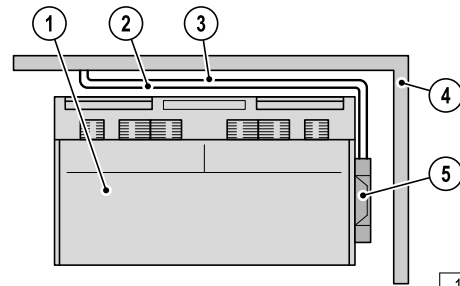

10027 / 0

1. Tanning unit
2. Cable set: external music line
3. Cable set: channel selection line
4. Cabin wall
5. Sound box (3D sound) with board 12962

**Permissible input voltage:**

Pre-amplifier: 600 mV to 3 V  
or  
Power amplifier: 5 V to 30 V

**Ergoline Prestige and Esprit series, Sunangel S 52**

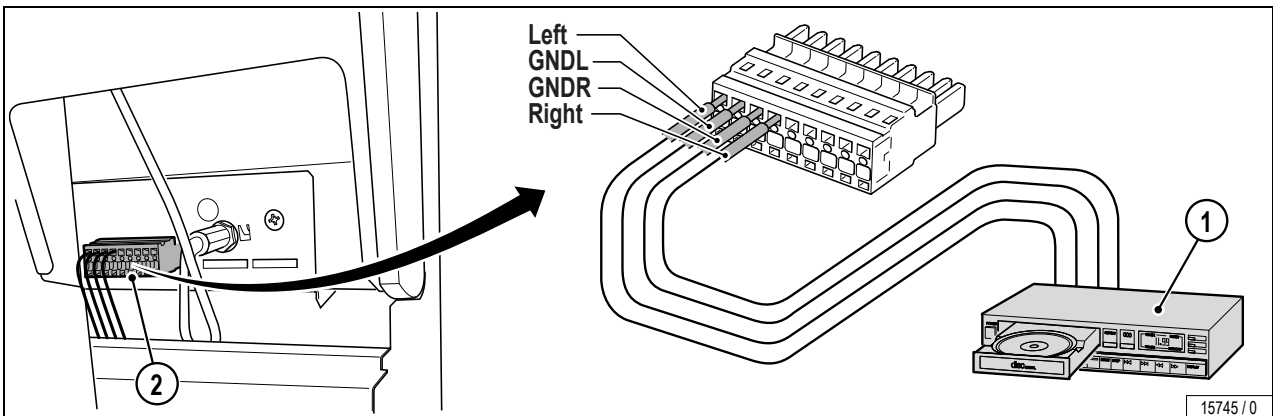

15745 / 0

1. CD player (or other playback devices)
2. Socket for connecting the cables to the sound box

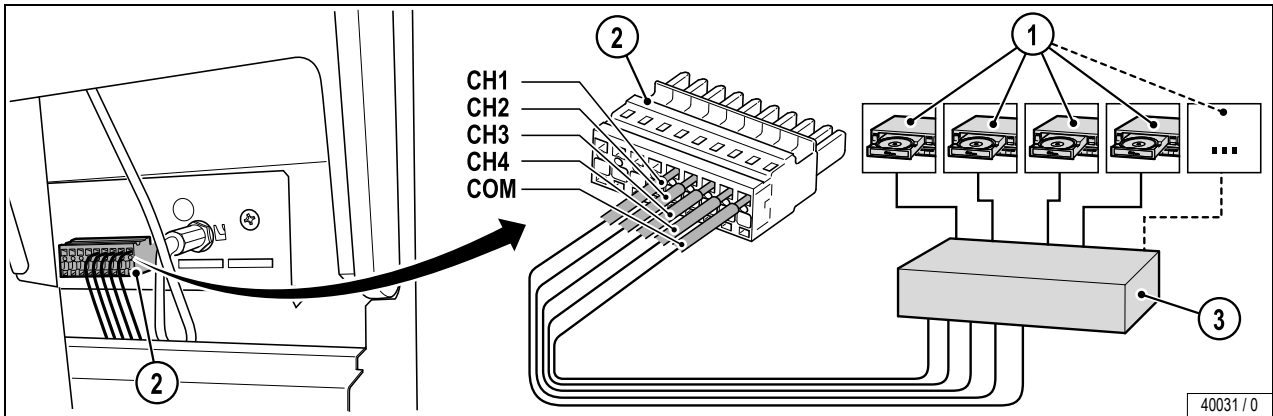

- 1. CD player (or other playback devices)
  - 2. Socket for connecting the cables to the sound box
  - 3. Distribution box
- Channel selection method: See page 36 and following.

**Ergoline Open Sun 1050**

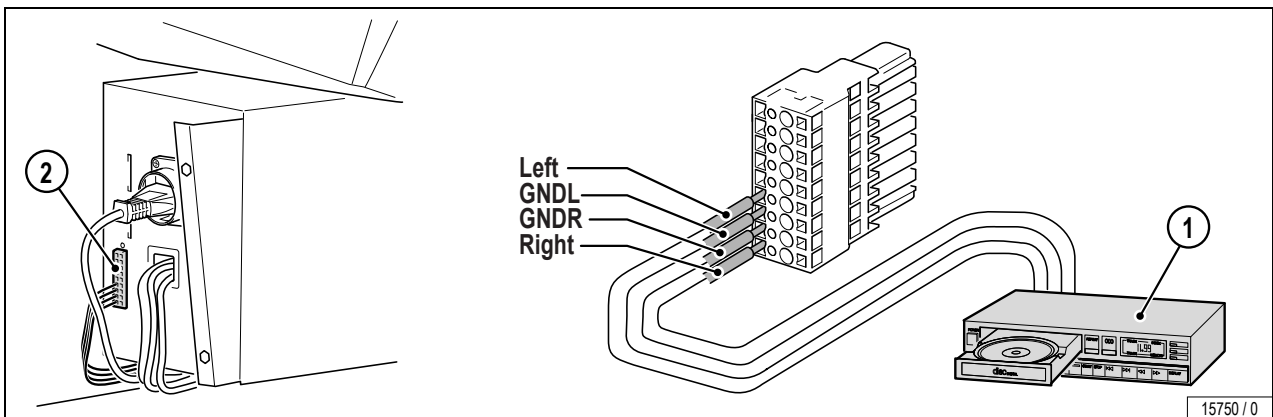

- 1. CD player (or other playback devices)
- 2. Socket for connecting the cables to the sound box

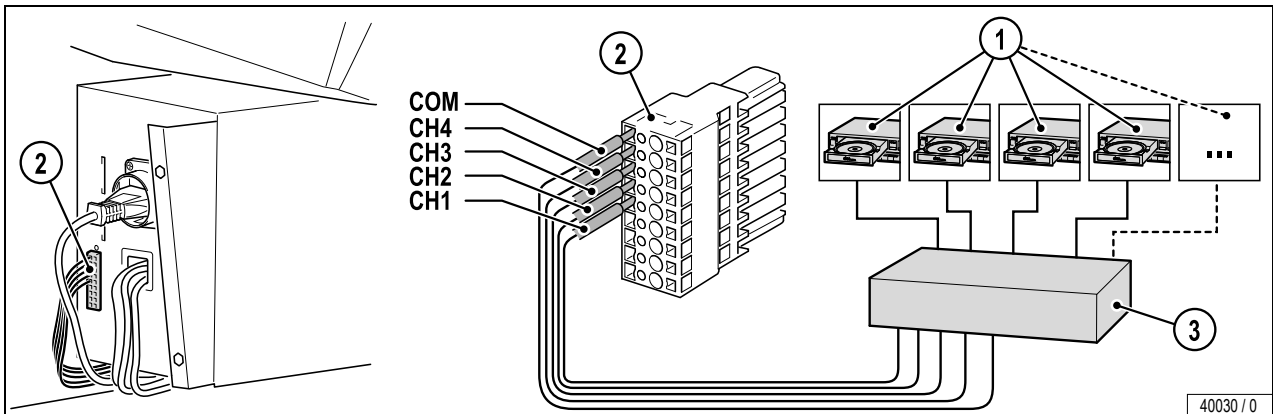

- 1. CD player (or other playback devices)
  - 2. Socket for connecting the cables to the sound box
  - 3. Distribution box
- Channel selection method: See page 36 and following.

Ergoline Affinity series, Inspiration series, Sunangel S 46, Soltron XXL-95, XL-75, L-65, M-60, S-55 and S-50

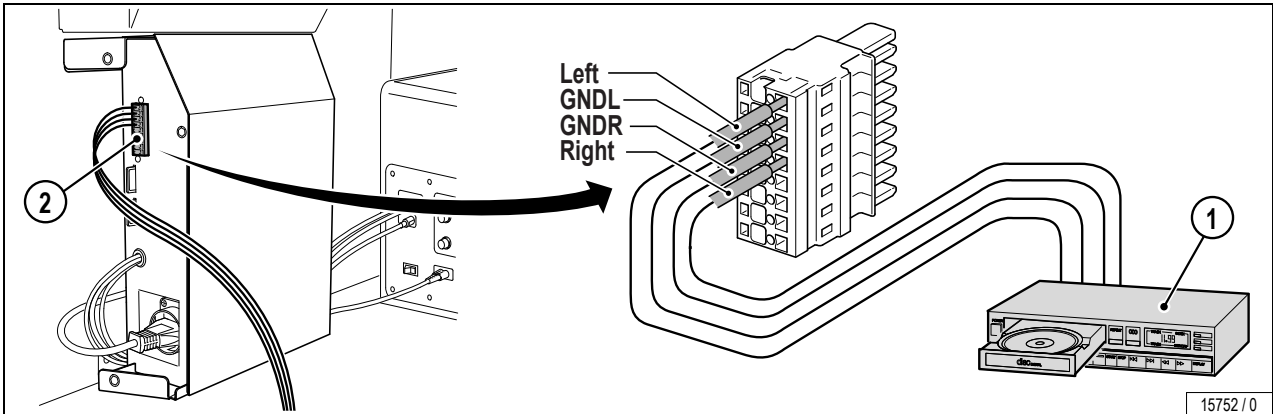

- 1. CD player (or other playback devices)
- 2. Socket for connecting the cables to the sound box

15752 / 0

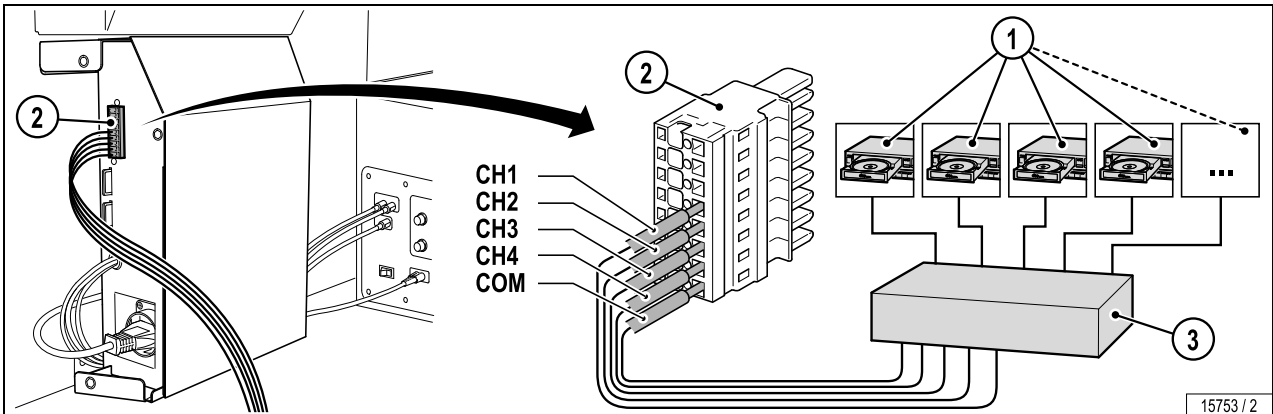

- 1. CD player (or other playback devices)
  - 2. Socket for connecting the cables to the sound box
  - 3. Distribution box
- Channel selection method: See page 36 and following.

15753 / 2

Ergoline Open Sun Pilot

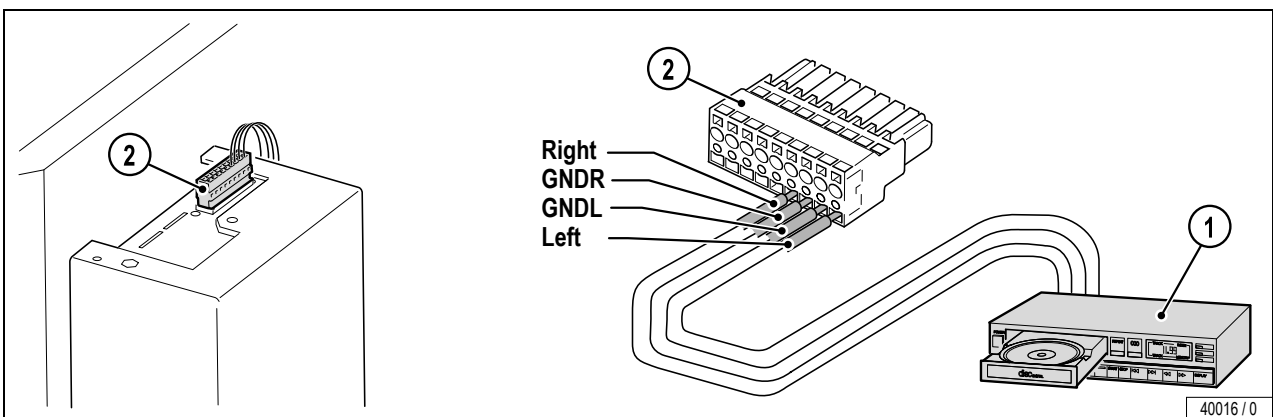

- 1. CD player (or other playback devices)
- 2. Socket for connecting the cables to the sound box

40016 / 0

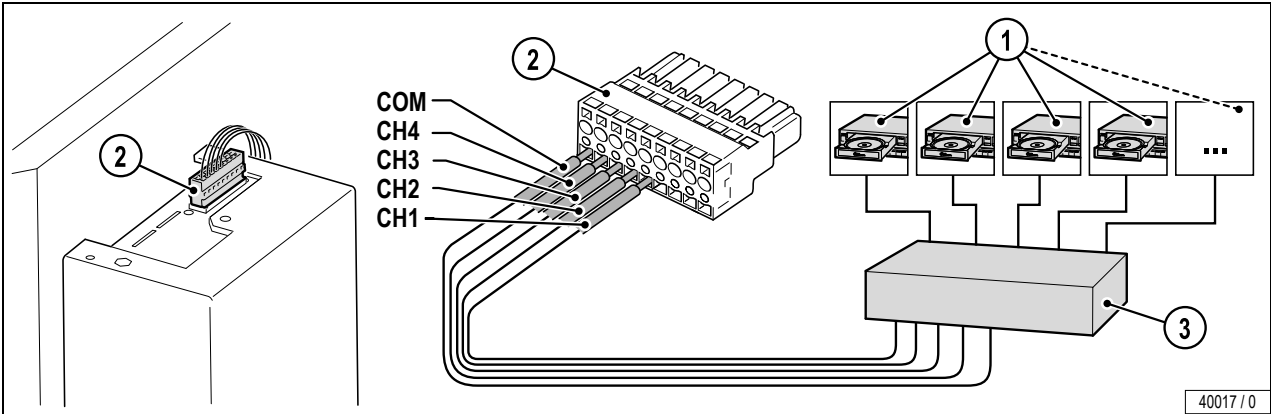

- 1. CD player (or other playback devices)
  - 2. Socket for connecting the cables to the sound box
  - 3. Distribution box
- Channel selection method: See page 36 and following.

**Ergoline Sunrise series, Soltron V-55 and V-50**

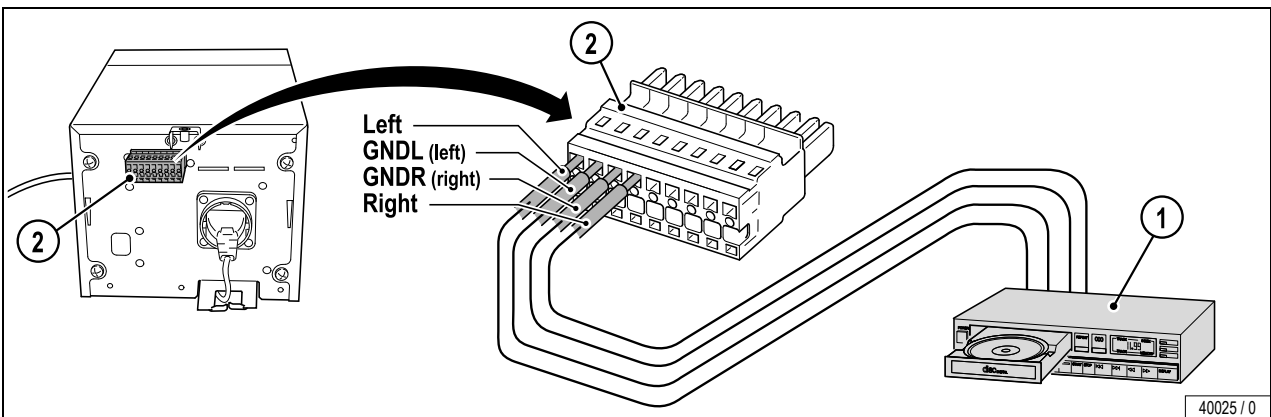

- 1. CD player (or other playback devices)
- 2. Socket for connecting the cables to the sound box

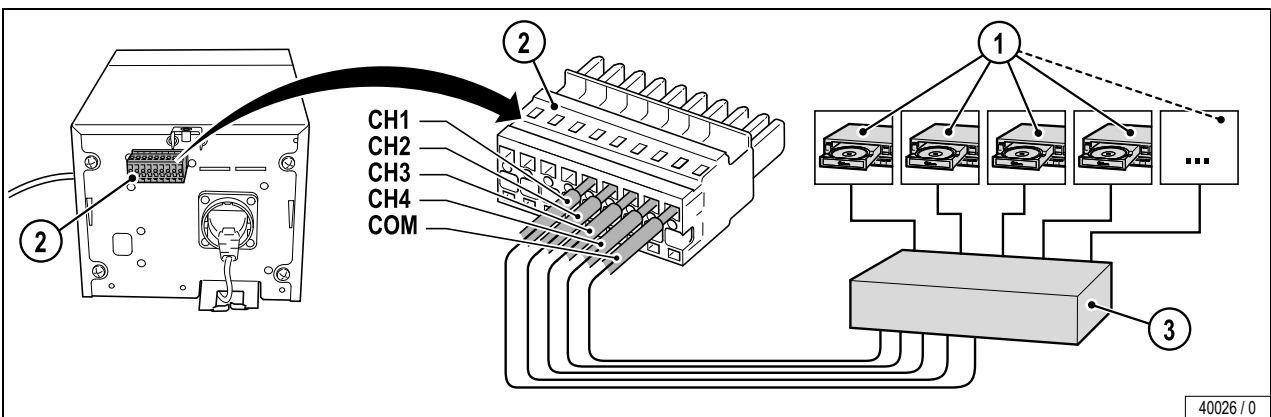

- 1. CD player (or other playback devices)
  - 2. Socket for connecting the cables to the sound box
  - 3. Distribution box
- Channel selection method: See page 36 and following.

## Connection options board 12962

### Input voltage:

Pre-amplifier: 600 mV to 3 V

or

Power amplifier: 5 V to 30 V

### Connection decimal channel selection method

One of up to four connected music sources can be selected.

1. Channel 1
2. Channel 2
3. Channel 3
4. Channel 4
5. Terminal block in sound box:
 

CH1	02
CH2	03
CH3	04
CH4	05
COM	01

6. Distribution box, music channel 1-4
7. Audio board 12962

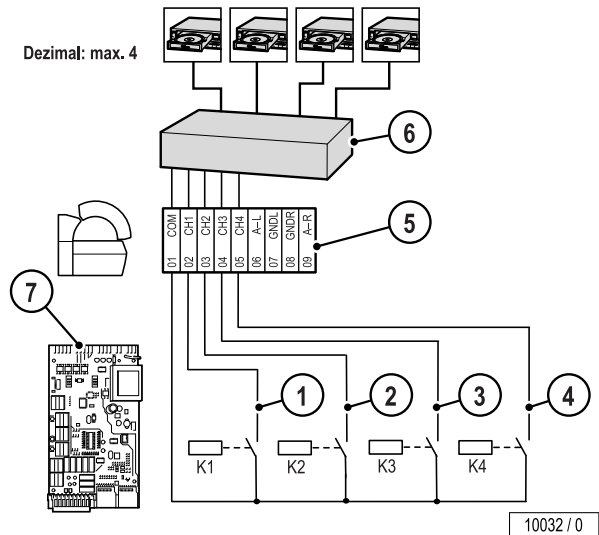

### Connection BCD channel selection method

One of up to 16 connected music sources can be selected.

1. Channel 1
2. Channel 2
3. Channel 3
4. Channel 4
5. Terminal block in sound box:
 

CH1	02
CH2	03
CH3	04
CH4	05
COM	01

6. Distribution box, music channel 1-16
7. Audio board 12962

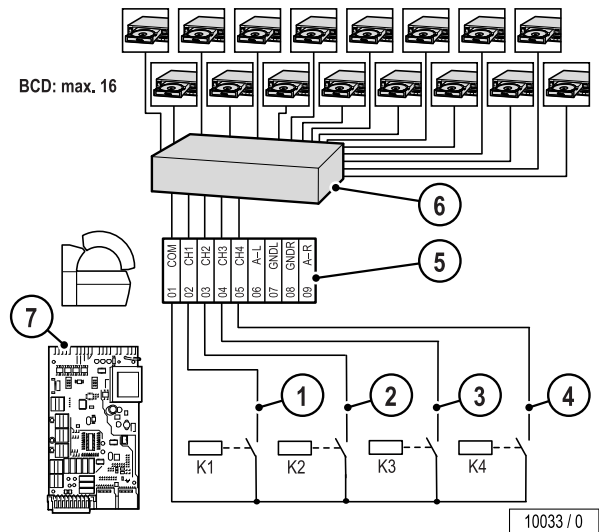

**Connection pulse channel selection method**

One of up to 16 connected music sources can be selected.

1. Channel 3
2. Channel 4
3. Terminal block in sound box:
 

CH1	02
CH2	03
CH3	04
CH4	05
COM	01
4. Distribution box, music channel 1-16
5. Audio board 12962

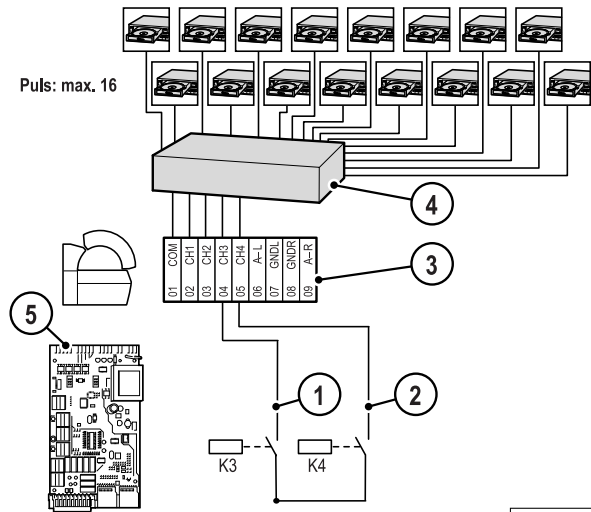

10034 / 0

**Connection without channel selection**

The connected music source can be switched on or off.

1. External music source
2. Terminal block in sound box:
 

Left	left channel +	06
GNDL	left channel -	07
GNDR	right channel -	08
Right	right channel +	09
3. Board 12962

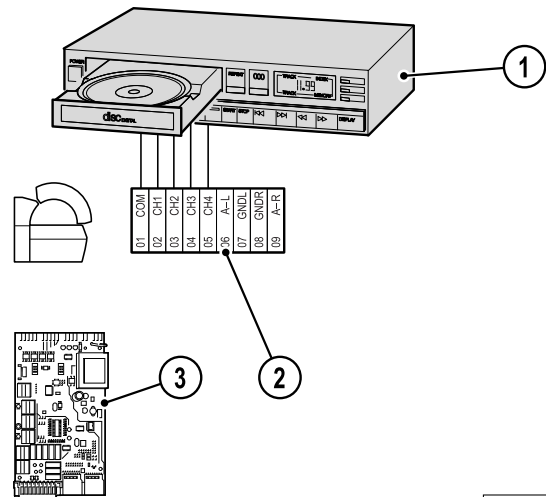

10039 / 0

## Connection options Stereo Sound

The salon's music system is connected via a terminal block in the tanning unit.

Depending on the music control software, there are up to 16 audio channels available. Tanning systems with audio kit enable the connection of a pre-amplifier, power amplifier or 100 V system.

### Input voltage:

Pre-amplifier: 600 mV to 3 V

or

Power amplifier: 5 V to 30 V

or

100 V system: 25 V to 150 V

	Excellence	Evolution	XL-70/M-55	M-50	Open Sun 550	Advantage 400 APS	Advantage 400	S-45	Advantage 350	S-40	Classic 200/300	Lounge	V-60	Vertical	Sunrise	V-55/V-50	V-45	342 Radius
Pre-amplifier 600 mV to 3 V	S	S	O	O	S	S	O	O	-	-	-	-	-	-	S	S	-	-
Power amplifier 5 V to 30 V	S	S	S	S	S	S	O	O	-	-	-	S	S	-	S	S	-	-
100 V system 25 V to 150 V	S	S	O	O	S	S	O	O	-	-	-	-	-	-	-	-	-	-
External music source (channel selection)	S	S	O	O	S	S	O	O	-	-	-	O	O	-	-	-	-	-
External music source (1 channel)	S	S	S	S	S	S	S	S	-	-	-	S	S	O	S	S	-	-
Direct connection	-	-	-	-	-	-	-	-	S	S	O	S	S	S	S	S	O	O

### Location of the terminal block on the units

Ergoline Excellence, Evolution, Soltron XL-70, M-55, M-50

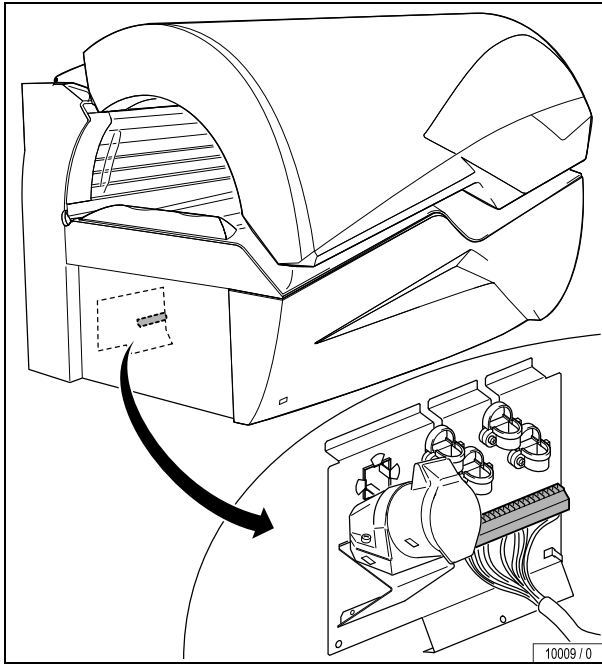

Ergoline Advantage 350/400 and Soltron S-40/S-45

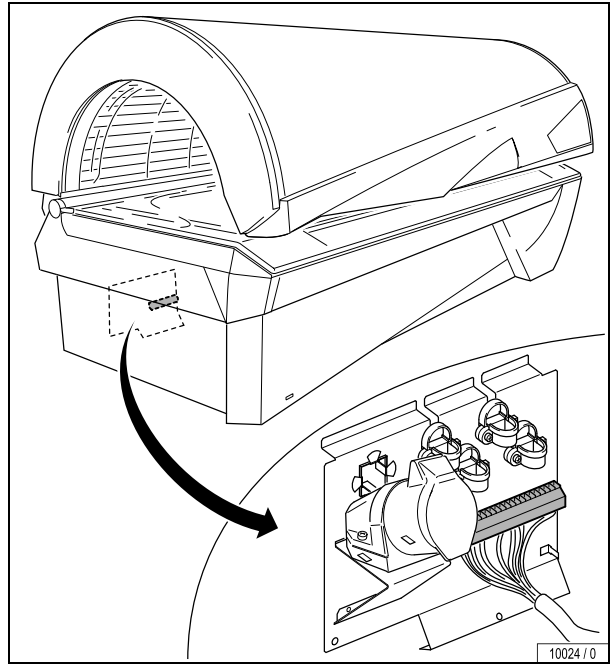

Ergoline Open Sun 550

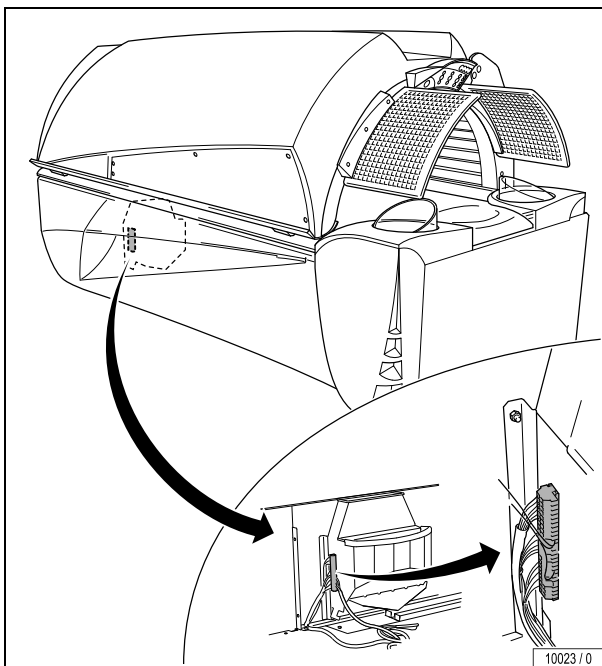



Ergoline Lounge/Soltron V-60

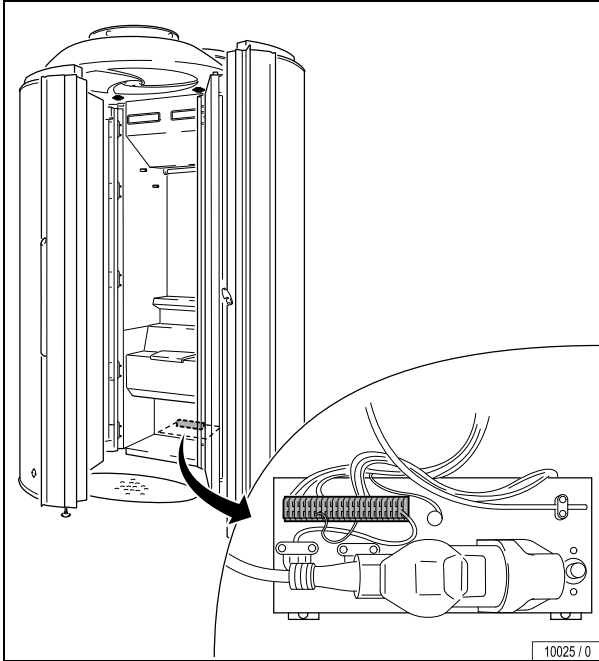

Soltron V-45 Coconut Shaker, V-45 Tangerine Toner

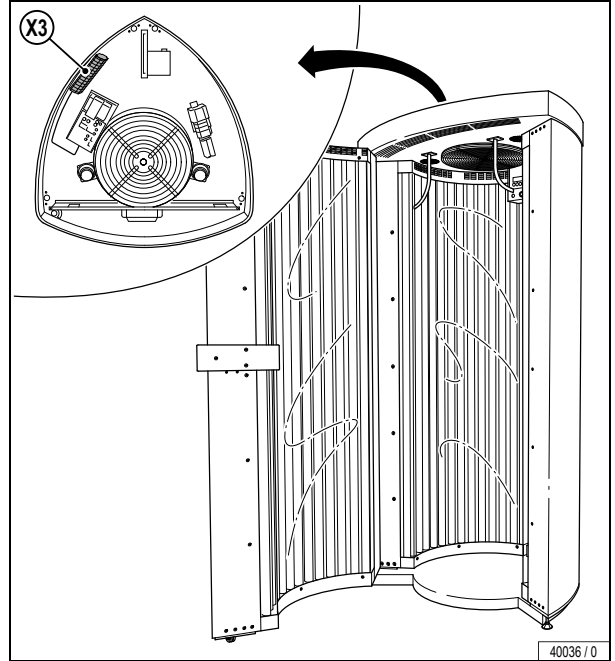

Ergoline Sunrise, Soltron V-55/V-50

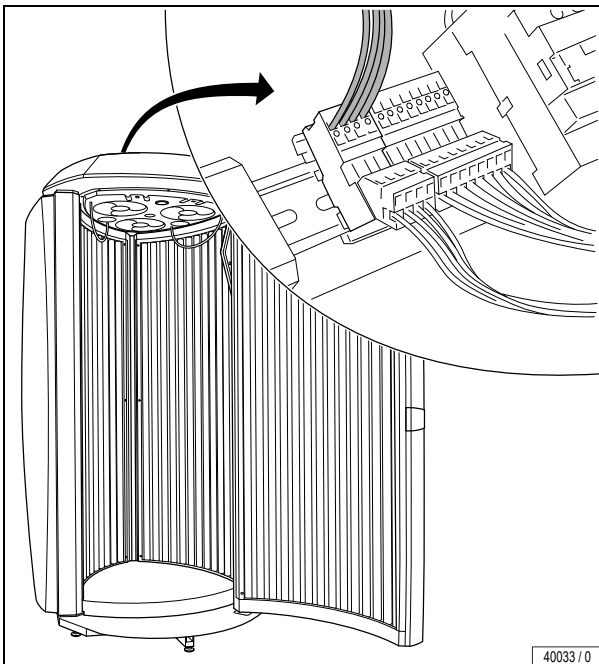

## Connection options board 12244

### Connection decimal channel selection method

One of up to four connected music sources can be selected.

1. Channel 1
2. Channel 2
3. Channel 3
4. Channel 4
5. Connection block in tanning device:
 

CH1	02
CH2	03
CH3	04
CH4	05
COM	01
6. Distribution box, music channel 1-4
7. Board 12244

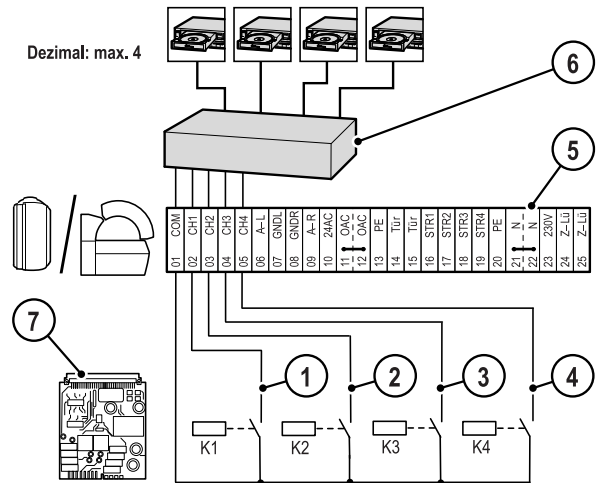

10028 / 0

### Connection BCD channel selection method

One of up to 16 connected music sources can be selected.

1. Channel 1
2. Channel 2
3. Channel 3
4. Channel 4
5. Connection block in tanning device:
 

CH1	02
CH2	03
CH3	04
CH4	05
COM	01
6. Distribution box, music channel 1-16
7. Board 12244

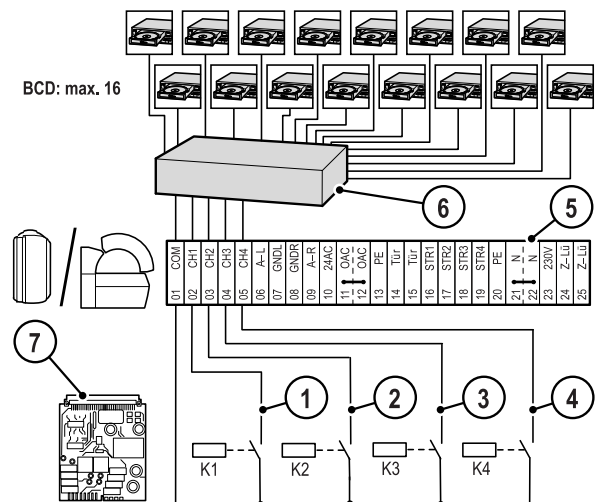

10029 / 0

**Connection pulse channel selection method**

One of up to 16 connected music sources can be selected.

1. Channel 3
2. Channel 4
3. Connection block in tanning device:
 

CH1	02
CH2	03
CH3	04
CH4	05
COM	01
4. Distribution box, music channel 1-16
5. Board 12244

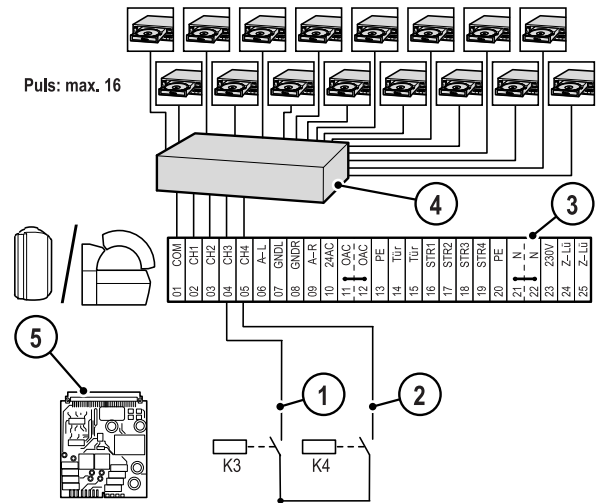

10030 / 0

**Connection without channel selection**

The connected music source can be switched on or off.

1. External music source
2. Terminal block in sound box:
 

Left	left channel +	06
GNDL	left channel -	07
GNDR	right channel -	08
Right	right channel +	09
3. Board 12244

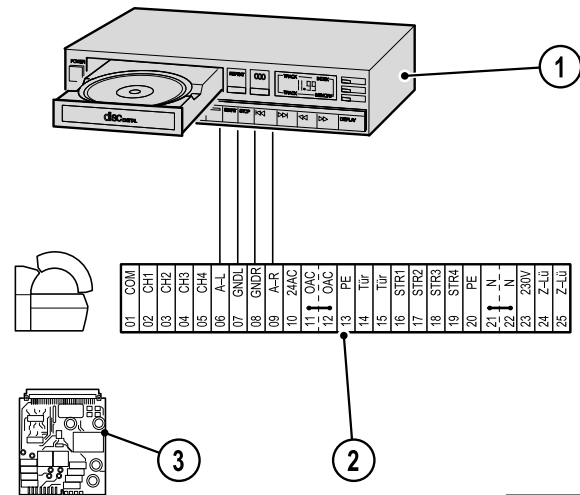

10038 / 0

## Connection options board 12243

### Connection without channel selection

A power amplifier must be connected. The volume of the connected music source can be adjusted.

Permissible input voltage: 5 V to 30 V (power amplifier)

1. External music source
2. Output amplifier
3. Terminal block in sound box:
 

Left	left channel +	06
GNDL	left channel -	07
GNDR	right channel -	08
Right	right channel +	09
4. Board 12243

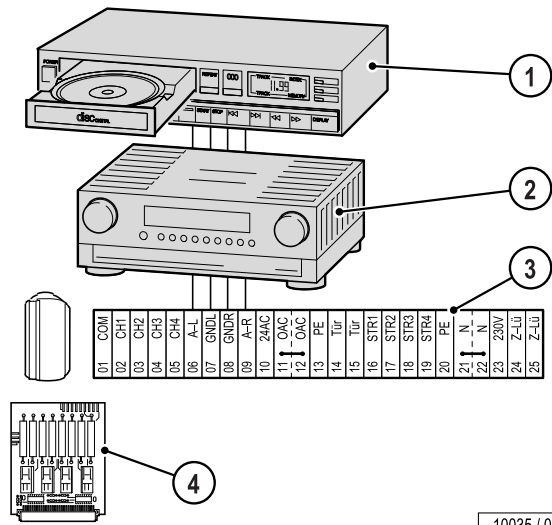

10035 / 0

## Connection options audio bridge 12320

### Connection without channel selection

Any playback device can be connected. The volume can not be adjusted in the tanning unit. The volume in the tanning unit (headphones or loudspeaker) depends on the power of the input signal (output power of the connected playback device, length of the connection line).

1. External music source
2. Terminal block in sound box:
 

Left	left channel +	06
GNDL	left channel -	07
GNDR	right channel -	08
Right	right channel +	09
3. Audio bridge 12320

## Connection options of the individual audio boards

### Ergoline Sunrise, Soltron V-55/V-50

Any playback device can be connected via a terminal on the tanning device.

Connection to a music system with channel selection is not possible.

Permissible input voltage:  
600 mV to 3 V (pre-amplifier)  
5 V to 30 V (power amplifier)

1. External music source
2. Connection block in tanning device (ST27):
 

Left	left channel +	1
GNDL	left channel -	2
GNDR	right channel -	3
Right	right channel +	4
3. Board

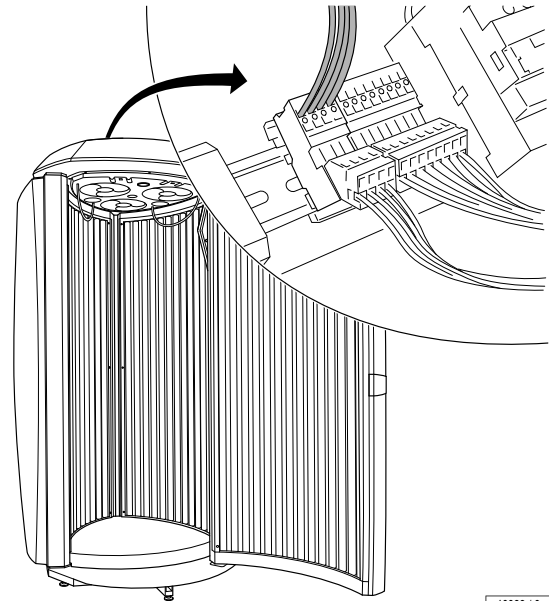

40033 / 0

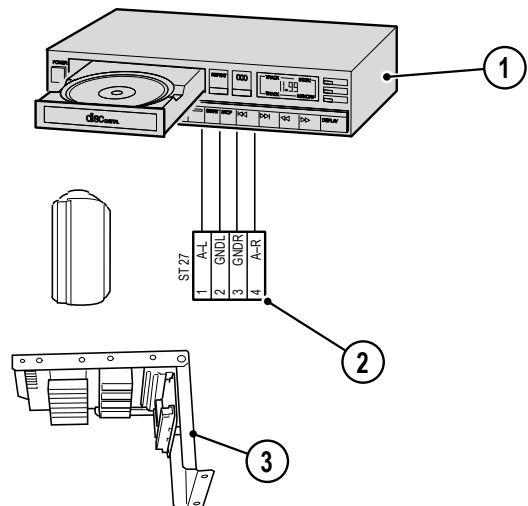

40034 / 0

### Ergoline Vertical

Sound system with audio board. A playback device is connected to two Cinch connectors on the outside of the tanning unit.

Permissible input voltage: 5 V to 30 V (power amplifier)

Connection to a music system with channel selection is not possible.

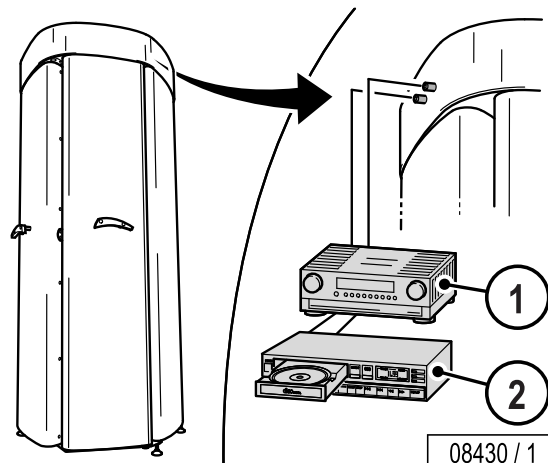

08430 / 1

**Soltron V-45, Sun Dash 342 Radius**

The audio circuit board with cable and stereo jack is located in the upper part where the connection wires (power and control) are fed into the device. With a 3.5 mm stereo jack, an audio source can be connected to the tanning device.

Permissible input voltage: The maximum permissible input power is 2 V RMS.

Connection to a music system with channel selection is not possible.

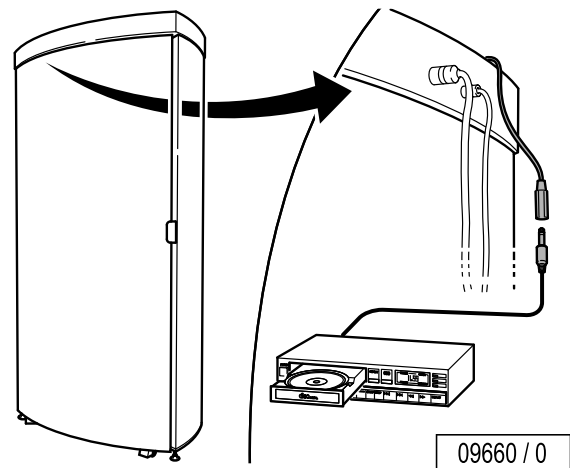

09660 / 0

**Soltron V-45 Coconut Shaker**

The audio circuit board is located in the upper part where the connection wires (power and control) are fed into the device. An audio source can be connected to the tanning device via the X3 clamp.

Permissible input voltage: The maximum permissible input power is 0.5 V RMS.

Connection to a music system with channel selection is not possible.

1. External music source
2. Connection block in tanning device (X3 clamp):
 

Left	left channel +	06
GNDL	left channel -	07
GNDR	right channel -	08
Right	right channel +	09
3. Board

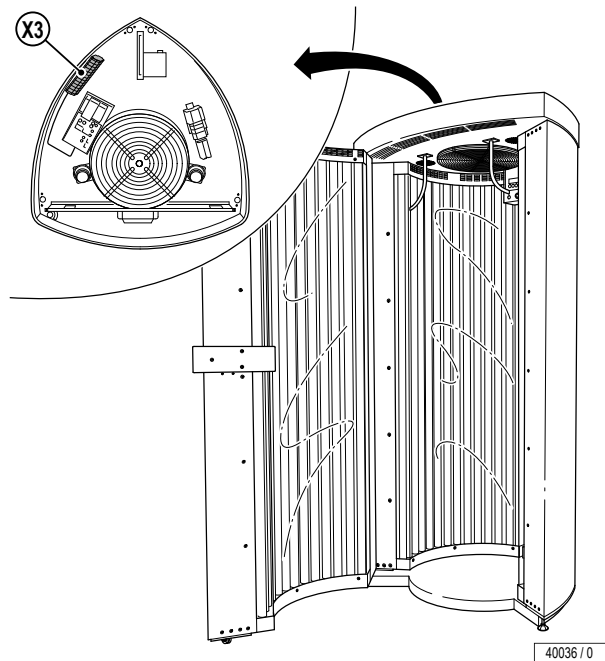

40036 / 0

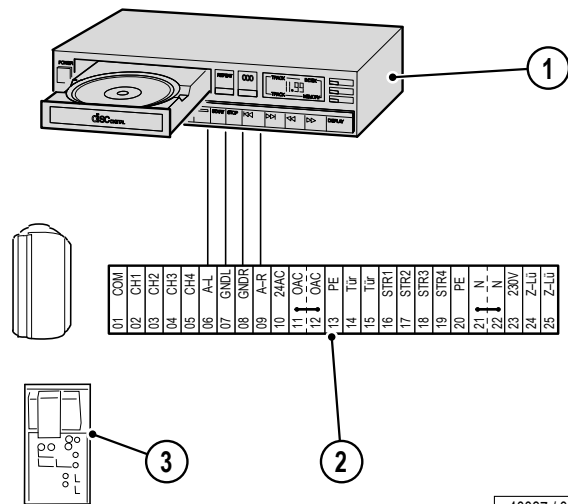

40037 / 0

## Controls and channel selection methods

Three different types of commercially available controls can be connected to the 3D sound and Stereo Sound systems:

- Units with decimal code connection
- Units with BCD code connection
- Units with pulse code connection

The channel control is set with BCD code by default. The 3D sound system allows the salon operator to set up a different control type. This is also possible for Stereo Sound systems using a Palm with access to the preset mode. Otherwise, please contact the Customer Service.

Examples<sup>1)</sup>:

Manufacturer	Channel selection	Max. no. of channels
Ergoline	Pulse	16
Beckmann	BCD	16
CSS	BCD	16
Tantec	BCD	16
SI	Pulse	16

The following tables show the states of the four relays of the sound system depending on the control type. The relays are located on the board "Audio amplifier"; switching is potential-free.

BCD				
Channel	Relay 4	Relay 3B	Relay 2B	Relay 1B
01	L	L	L	L
02	H	L	L	L
03	L	H	L	L
04	H	H	L	L
05	L	L	H	L
06	H	L	H	L
07	L	H	H	L
08	H	H	H	L
09	L	L	L	H
10	H	L	L	H
11	L	H	L	H
12	H	H	L	H
13	L	L	H	L
14	H	L	H	H
15	L	H	H	H
16	H	H	H	H

Decimal				
Channel	Relay 4	Relay 3B	Relay 2B	Relay 1B
01	H	L	L	L
02	L	H	L	L
03	L	L	H	L
04	L	L	L	H
XX	L	L	L	L

In the "Pulse" setting, the relays only switch for a short time.

Pulse				
Channel	Relay 4	Relay 3B	Relay 2B	Relay 1B
+	H	L	L	L
-	L	H	L	L

1) We assume no responsibility for the accuracy of this information.

## Using SD cards



### Note:

You must obtain the right to reproduce copyrighted music titles before being able to play these in your salon! Unauthorized use may result in severe civil and criminal penalties which could adversely affect the company's operations.

The current 3D sound systems offer the possibility to provide the user of the tanning unit with a custom compilation of music titles or texts by means of an SD card.

An SD card (Secure Digital Card) is a digital storage medium which is generally used in devices such as digital cameras, MP3 players, PDAs, etc. Conventional SD cards can store from 8 MB up to 2 GB of data. The storage capacities of the new SD-HC cards (HC for High Capacity) start at 4 GB.



### Note:

The new SDHC/SD-2.0 cards can not be used in the 3D sound box.

Conventional SD cards are also available with storage capacities > of 2 GB. However, the SD specification does not allow for higher storage capacities and this often leads to cards not being read correctly.

SD cards incorporate a write protection switch that prevents unintentional overwriting of data (similar to floppy disks).

### Reading SD cards

To read an SD card you need a suitable card reader. Card readers are available as standalone devices but they are generally connected to a PC via a USB connection. Many PCs/notebooks are equipped with an internal card reader.

### Writing SD cards

Every card reader that can read from an SD card can also write on an SD card. Just as with a floppy disk or a USB memory stick, the source data are simply copied onto the card. Equally, the data can also be deleted or overwritten.

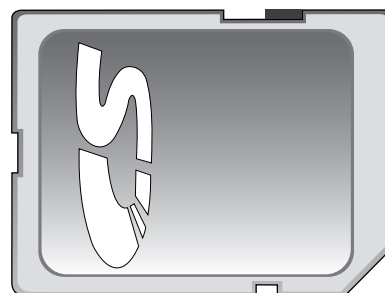

10016 / 0

### Data format on SD cards

As a rule, an SD card can be formatted as required and supports all common data formats.

### Specification of the internal music SD card for the Ergoline 3D sound system

<b>File system:</b>	FAT (FAT 16) <sup>1)</sup>
<b>Data format:</b>	MP3 (with ID3v1 tag <sup>2)</sup> ), Wave <sup>3)</sup>
<b>Storage capacity:</b>	up to 1 GB

1) The format FAT 32 is also possible with the latest software package (>1501551-05).

2) Requirement for full text display of music titles

3) The Wave format requires significantly more storage space than MP3 and is therefore only mentioned here for the sake of completeness.

### MP3 files

MP3 stands for ISO MPEG Audio Layer 3. It is a data format for the compression of audio data.

Raw audio data require large amounts of storage space. It is possible to significantly reduce the amount of data by removing part of the sound. In an MP3 player (or another playback device), these data are converted back into sound which only few people can differentiate from the original music piece.

A 512 MB SD card can store up to 200 music titles, a CD can hold more than 11 hours of music, and a DVD can fit more than 50 complete albums.

As a standard, an MP3 file does not contain any information on the contents of the music file. MP3 files with ID3 tags are required to display title, performer, album, etc.

MP3 files can now be obtained e.g. from many online music stores on the Internet. All you need to do then is to copy these files onto the SD card.

You can also convert existing music tracks into MP3 files using freely available software (e.g. Musicmatch Jukebox).



## How to create an SD card for 3D sound

There are two ways of storing your own music compilations on an SD card: You can convert audio data from CD or DVD into MP3 or obtain ready-to-use MP3 files from the Internet. It is important to ensure that the SD card is formatted correctly.

This section describes the necessary steps. The individual steps are explained by way of screenshots created with Microsoft Windows XP Professional<sup>1)</sup> using Windows Explorer and the freeware Musicmatch Jukebox<sup>2)</sup>.

### Formatting an SD card

- Connect the card reader to the PC.
- Insert the SD card into the card reader.  
A new Explorer window will normally open automatically.
- If no window opens: Go to the Windows Desktop and double-click on *My Computer*.



#### Note:

The configuration shown will vary depending on the Windows version and your personal settings. You may need to open further directories in order to find the correct drive.

If the card reader is able to read more than one card type, several drives of the type “Removable Disk” will be shown. If you click on an empty drive, you will be prompted to insert a disk.

- Click with the right mouse key on the drive with the SD card and select the command *Format*.

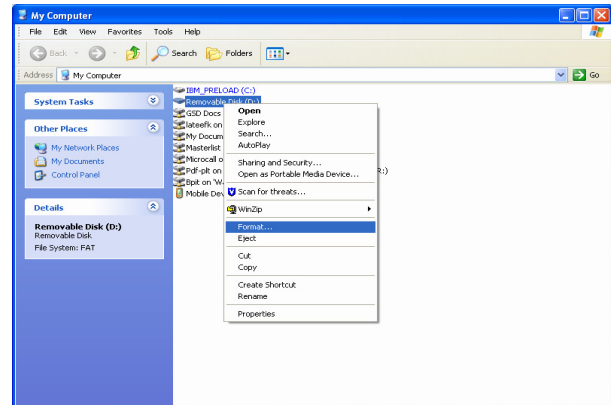

- In the window *Format Removable Disk* select under *Capacity* the size of your SD card.  
If your card was pre-formatted, the storage size will be shown automatically. If you don't know for what file system the card is formatted, proceed as follows.
- In the drop-down menu *File system* select *FAT*.



#### Note:

If you select a different file system, your SD card will not be read by the tanning unit.

- Start the formatting process.

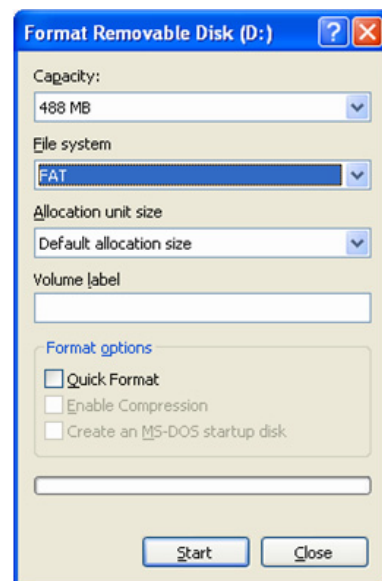

1) Copyright 1981-2001 Microsoft Corporation

2) Copyright 1998-2004 Musicmatch, Inc.

- If the SD card contains any previous data you will be warned about data loss. Click on *OK* if the existing data can be erased.

If you are unsure, click on *Cancel* to check the data and back them up on the hard disk, if necessary.

Once the formatting process has been completed, you will be able to write on the SD card.

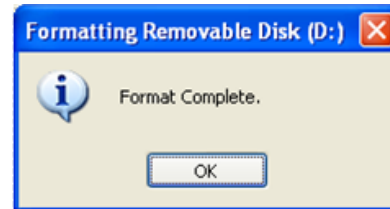

### Problems with SD cards

SD cards can be write-protected: the write protection is activated or deactivated with a slider on the side of the card (similar to 3.5" floppy disks).

Check the write protection if the following error message appears during the formatting process.



**Warning! Risk of data loss!**

You must stop the USB device prior to removing the SD card or unplugging the card reader or MP3 player from the PC (*Safely remove hardware*).



- On the Windows task bar click on the symbol *Safely remove hardware* and finalise the connection to the USB device.
- Only then will it be safe to pull out the card from the card reader or the USB plug from your PC.
- Check if the write protection is activated (slider in position 1) or deactivated (slider in position 2).
- If necessary, deactivate the write protection and repeat the formatting procedure.



**Note:**

If you are unable to format or write on an SD card, it is possible that the card itself may be damaged or that the card reader is not working properly.

- To be sure, verify that the slider is in the topmost position and not in an intermediate position.
- A missing slider can also cause problems: in this case, you can try to cover half of the opening with adhesive tape in order to simulate the deactivated write protection.
- Format or write on another SD card to check the correct functioning of the card reader.

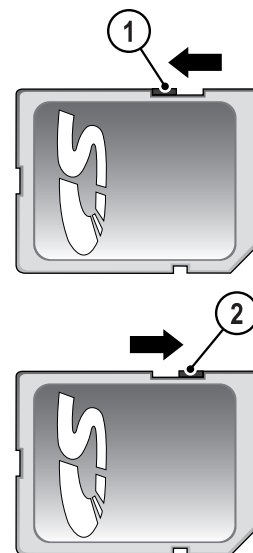

10041 / 0

**Creating MP3 files**

Example: Converting files from a CD into MP3.  
Observe the national usage rights of CDs and music titles!

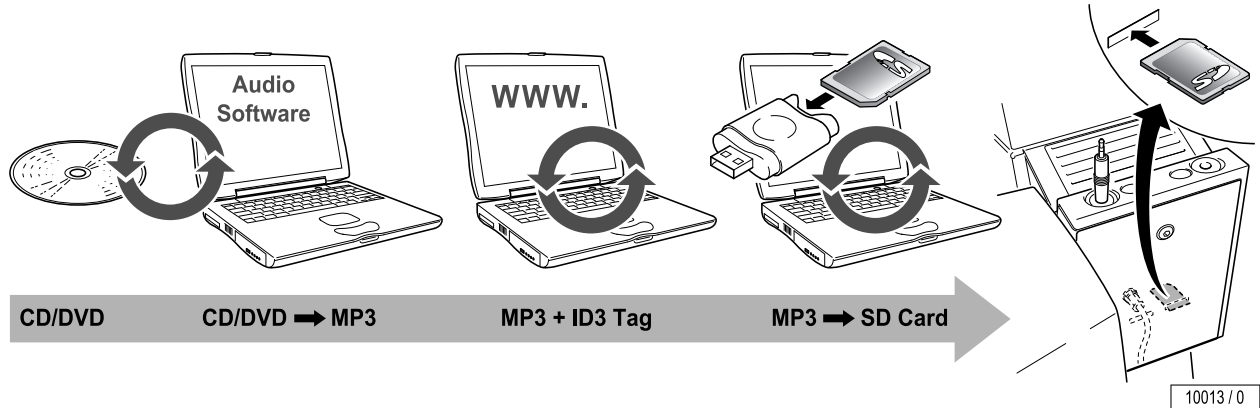

**Note:**

For creating ID3 tags, Musicmatch requires access to the Internet.

- Run the conversion software e.g. Musicmatch Jukebox.
- Insert a CD.

**Note:**

If any advertising windows appear in the meantime, close them in order to return to the actual program window (left-click on the cross at the top right corner of the window).

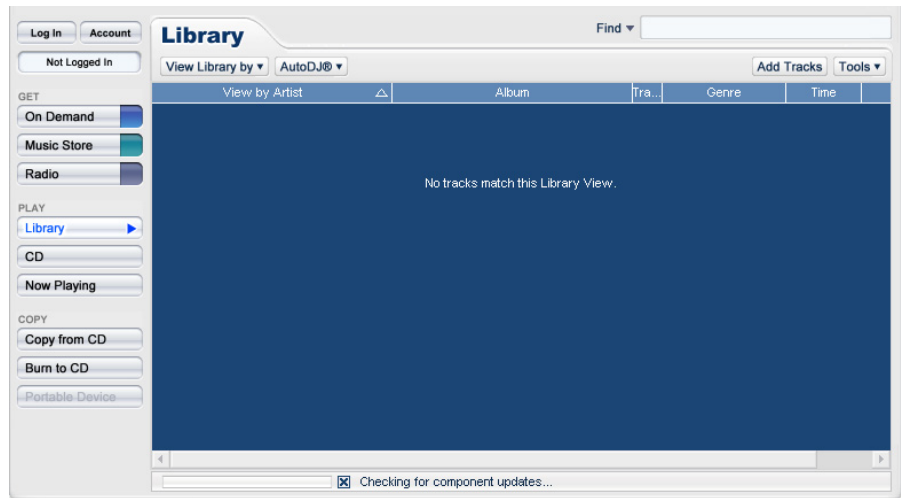

The contents of the CD are shown on the upper right hand side of the program window. If the performer and the title are not shown, go to section *No title information / Missing ID tags* on page 53.

You can also point with the mouse cursor on the button *CD* to obtain information on the contents of the CD.

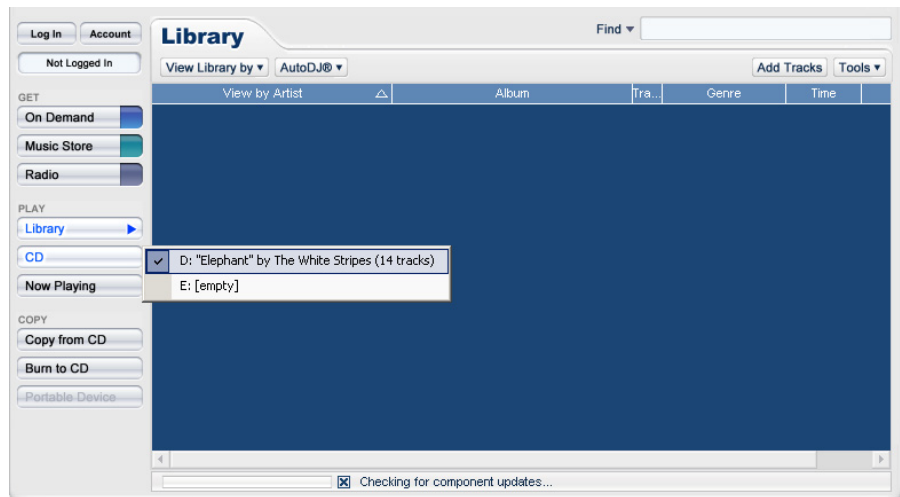

**Note:**

Apart from copying and writing music files, Musicmatch Jukebox can also play them back. Before being able to copy the files from the CD, you will probably have to turn off the CD drive's autorun function.

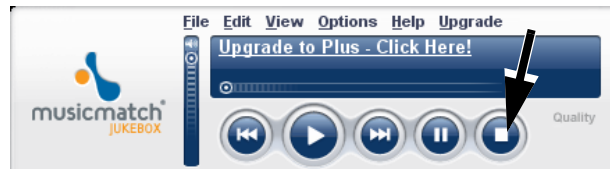

- Click on the button on the right hand side.
- Use the mouse to drag one of the titles from the window on the top right hand side into the main program field.

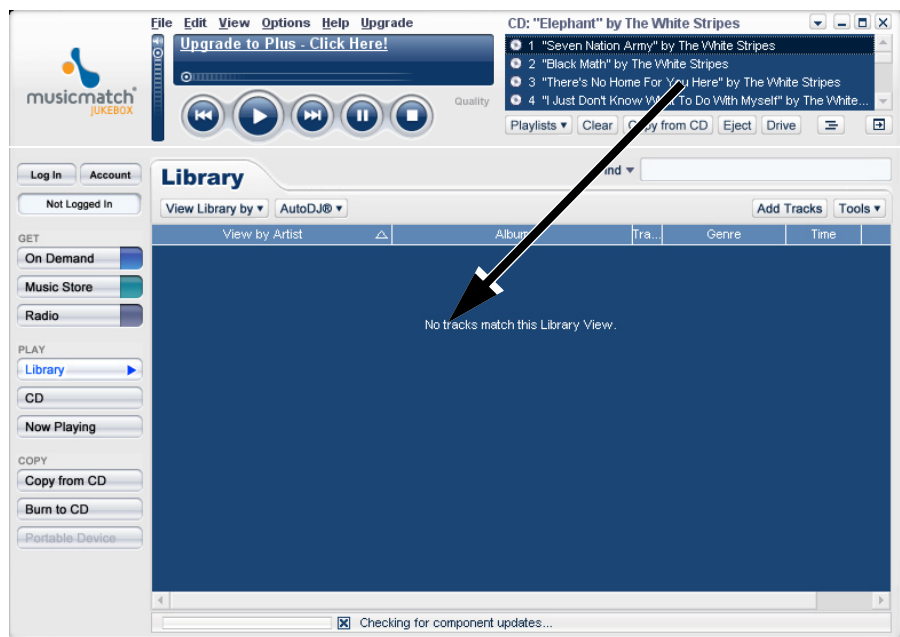

- Click on Yes in the message window to start the recorder.



- Unselect the checkbox to the left of the tracks that are not to be converted.
- Click on *Start Copy*. The progress of the copy process is shown in the window.

When copying, the music tracks are automatically stored as MP3 files with ID3 tag.

Once the copy process has been completed, you may close Musicmatch Recorder or insert a new CD to add further titles.



- In this way, the SD card will contain your own music compilation.

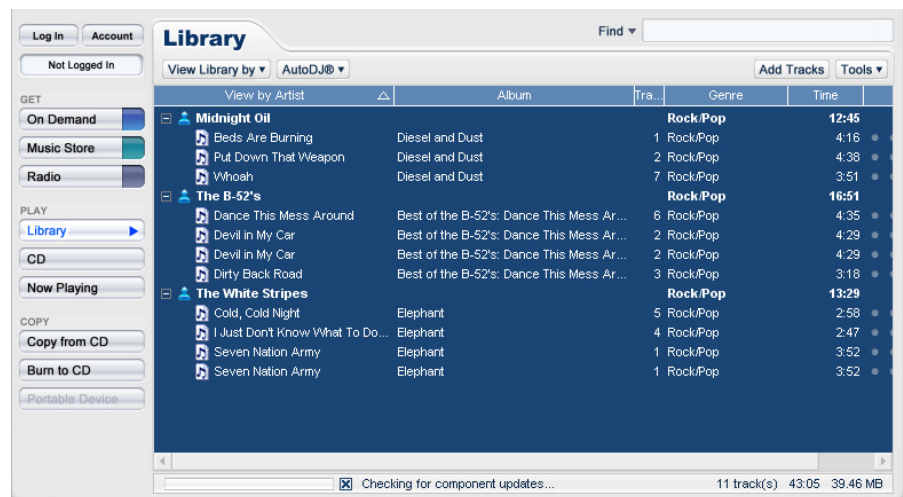

**No title information / Missing ID tags**

If the title and the performer of the track are not available, by default, Musicmatch looks for this information on the Internet. In this way, you will automatically obtain MP3 files with ID3 tags.

You may be prompted to select the matching album or music title from a list.

- Select the matching album in the window *Tag Lookup Results*.
- Click on *Accept Selected Tags*.

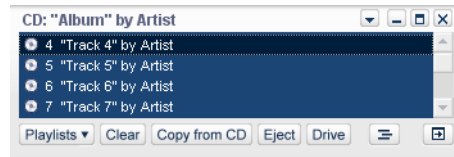

**To start the tag search manually:**

- In the menu *Edit Track Information* select *Track Info from Filename*.

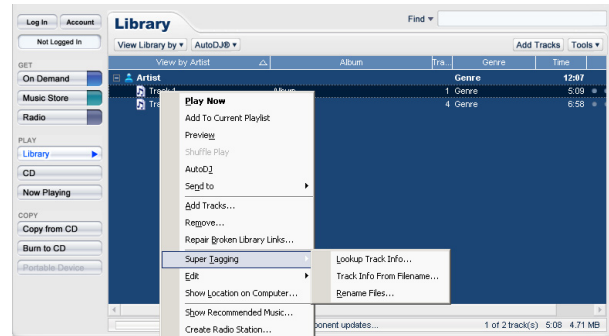

- Click on *OK* when all the information is correct.
- In Musicmatch Recorder, select the titles from the CD, which are to be copied into the library.

**Storing MP3 files on the SD card**

Once all the tracks which are to be transferred to the SD card have been copied:

- In the menu *File* select *Send to portable device*.

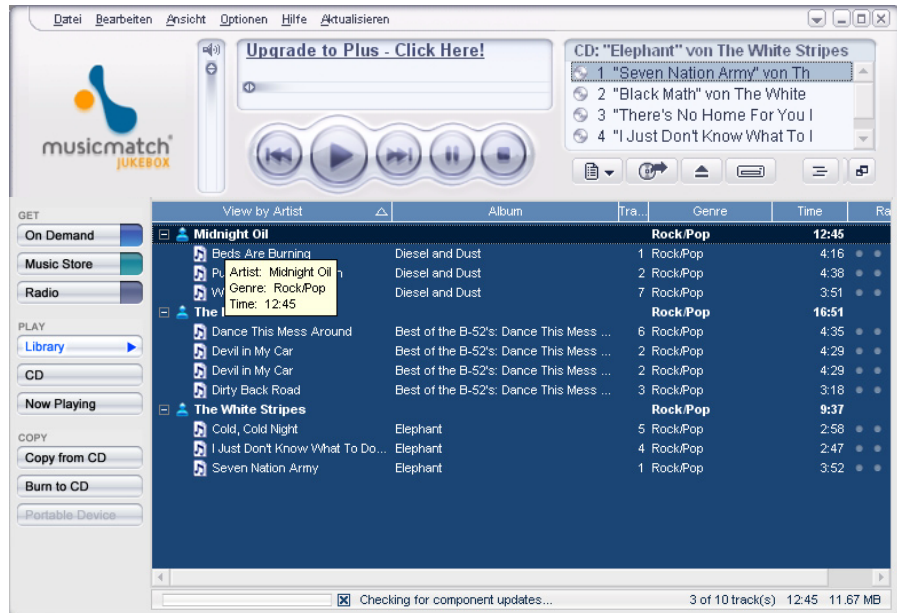

The window *Portable Device Manager* will open.

An advertising song from the software company may be automatically added to the list. Simply select the track in the list and press [Del] (in the next message window, click Yes to confirm).

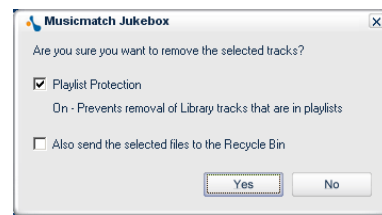

- Click on *Add Tracks* to open the library list.



- Open one of the category folders by double-clicking it.

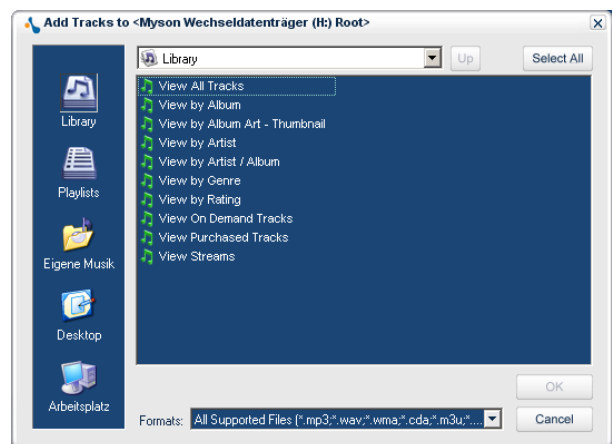

- Select all the folders to transfer all the files from the library list.

If you are planning to copy tracks onto different SD cards, you can also open one of the category folders shown for individual track selection.

- Click on *Add Tracks* to copy the data.  
The progress of the copy process is shown.



**Note:**

Musicmatch Jukebox automatically stores the MP3 files without folders on the SD card. If you copy the data using a different method, be advised that in the tanning unit only the tracks stored on the root directory of the SD card will be played back.

**Do not spread the files over several folders!**

If no progress can be detected in the Portable Device Manager for a longer period of time, check the write protection on the SD card – see *Problems with SD cards* on page 49.

The copy process has been completed when all the tracks in the *Portable Device Manager* are shown.

- Close the window (click on the cross at the top right corner of the window).
- You can now also exit Musicmatch.



**Warning! Risk of data loss!**

You must stop the USB device prior to removing the SD card or unplugging the card reader or MP3 player from the PC (*Safely remove hardware*).



- On the Windows task bar click on the symbol *Safely remove hardware* and finalise the connection to the USB device.
- Only then will it be safe to pull out the card from the card reader or the USB plug from your PC.

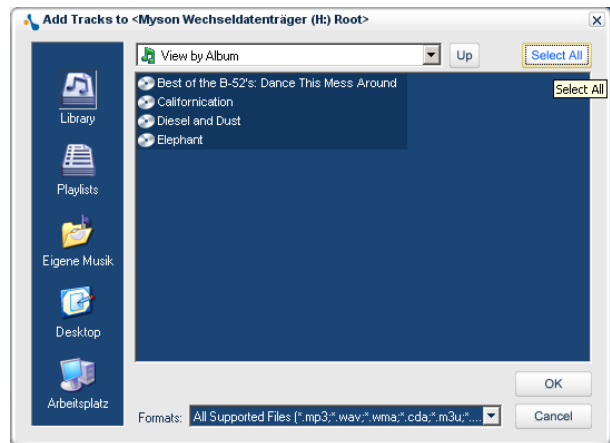



Using existing MP3 files

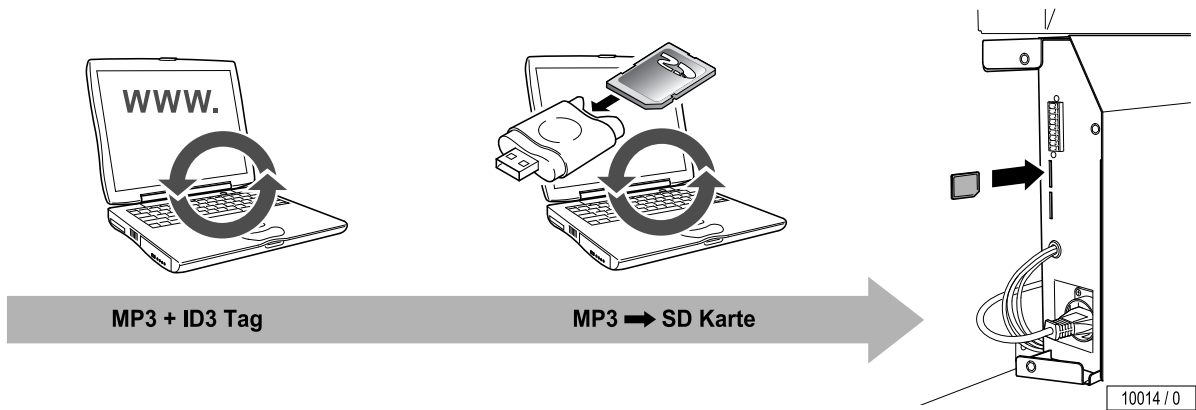

Example: Storing files from the Internet on the SD card.<sup>1)</sup>

- Save the MP3 files in a folder on your PC and open an Explorer window for this folder.

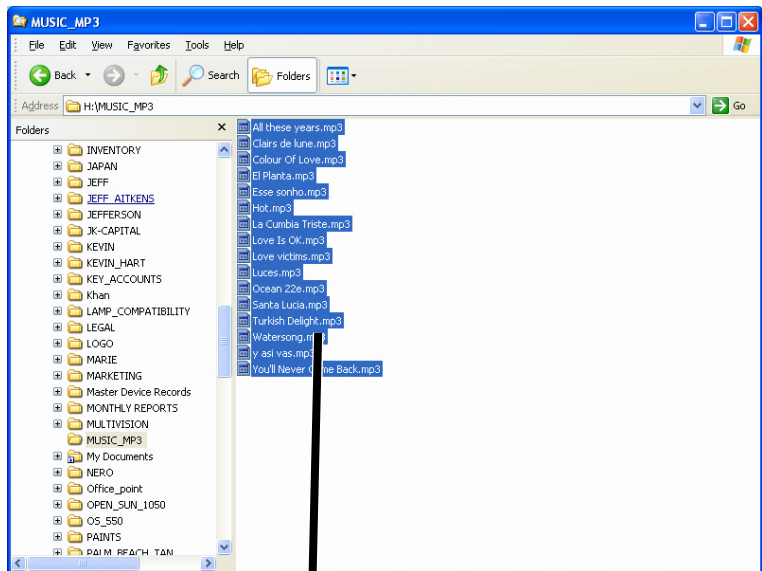

- Insert the SD card into a card reader connected to this PC.
- If necessary, open an Explorer window for the SD card (you can start several instances of Explorer).
- Change over to the window with the MP3 files and drag them to the SD card window.

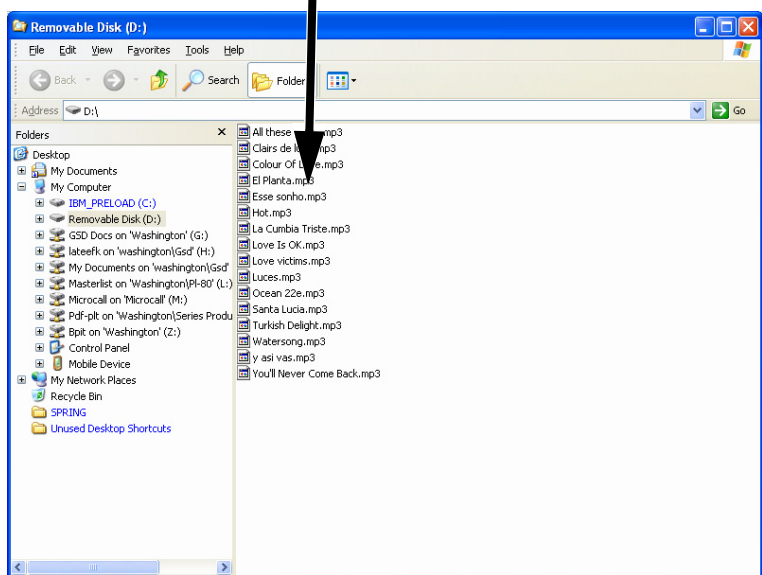

**Note:**  
Please be advised that in the tanning unit only the tracks stored on the root directory of the SD card will be played back  
**Do not spread the files over several folders!**

<sup>1)</sup> You must obtain the right to reproduce copyrighted music titles before being able to play these in your salon!

The data will be copied.

Wait for the copy process to complete before removing the SD card.



**Warning! Risk of data loss!**

You must stop the USB device prior to removing the SD card or unplugging the card reader or MP3 player from the PC (*Safely remove hardware*).

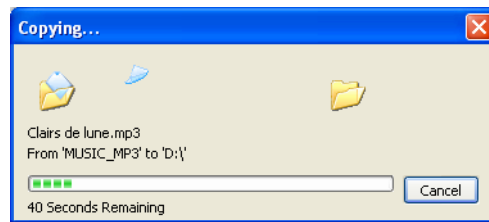

- On the Windows task bar click on the symbol *Safely remove hardware* and finalise the connection to the USB device.
- Only then will it be safe to pull out the card from the card reader or the USB plug from your PC.

## Checklist audio presets (3D sound)

The checklist will help you document presets, which you can then apply to other equipment with little effort. It is not yet possible to automatically transfer presets to other units.

No. in menu Presettings:	Applies to:	Setting range:	Chosen setting:																																													
-022	Display of the current software version of the audio controller	—	<input type="checkbox"/> <input type="checkbox"/> <input type="checkbox"/>																																													
-301	Activating / deactivating the Voice Guide*	ON = activated OFF = deactivated	<input type="checkbox"/> <input type="checkbox"/> <input type="checkbox"/>																																													
-302	Music inputs*	Selection of the audio source x = activated - = deactivated	<input type="checkbox"/>																																													
<table border="1"> <thead> <tr> <th>Setting</th> <th>Music off</th> <th>Studio channels</th> <th>Music selection (SD-card)</th> <th>Own music (MP3)</th> </tr> </thead> <tbody> <tr> <td>0</td> <td>X</td> <td>-</td> <td>-</td> <td>-</td> </tr> <tr> <td>1</td> <td>-</td> <td>X</td> <td>-</td> <td>-</td> </tr> <tr> <td>2</td> <td>-</td> <td>-</td> <td>X</td> <td>-</td> </tr> <tr> <td>3</td> <td>-</td> <td>X</td> <td>X</td> <td>-</td> </tr> <tr> <td>4</td> <td>-</td> <td>-</td> <td>-</td> <td>X</td> </tr> <tr> <td>5</td> <td>-</td> <td>X</td> <td>-</td> <td>X</td> </tr> <tr> <td>6</td> <td>-</td> <td>-</td> <td>X</td> <td>X</td> </tr> <tr> <td>7</td> <td>-</td> <td>X</td> <td>X</td> <td>X</td> </tr> </tbody> </table>				Setting	Music off	Studio channels	Music selection (SD-card)	Own music (MP3)	0	X	-	-	-	1	-	X	-	-	2	-	-	X	-	3	-	X	X	-	4	-	-	-	X	5	-	X	-	X	6	-	-	X	X	7	-	X	X	X
Setting	Music off	Studio channels	Music selection (SD-card)	Own music (MP3)																																												
0	X	-	-	-																																												
1	-	X	-	-																																												
2	-	-	X	-																																												
3	-	X	X	-																																												
4	-	-	-	X																																												
5	-	X	-	X																																												
6	-	-	X	X																																												
7	-	X	X	X																																												
-303	Active audio source*	Select the audio sources for setting the maximum volume: 0 = Music off 1 = Studio channels 2 = Own music 3 = Music selection (SD-card) 4 = Voice Guide	<input type="checkbox"/>																																													
-304	Basic volume level*	Maximum volume setting	<input type="checkbox"/>																																													
-305	Volume tanning*	Volume at tanning start	<input type="checkbox"/>																																													
-306	Volume headphones*	Headphone volume at tanning start	<input type="checkbox"/>																																													
-307	Volume Standby*	Loudspeaker standby volume	<input type="checkbox"/>																																													
-308	Bass*	Bass setting	<input type="checkbox"/>																																													

No. in menu Presettings:	Applies to:	Setting range:	Chosen setting:
--------------------------	-------------	----------------	-----------------

-309 Height\* Height setting

-311 Start input Audio sources for tanning start and standby  
 x = activated  
 - = deactivated

Setting	Tanning start			Standby			
	Music selection (SD-card)	Own music (MP3)	Studio channels	Music off	Music selection (SD-card)	Own music (MP3)	Studio channels
0	X	-	-	X	-	-	-
1	X	-	-	-	X	-	-
2	X	-	-	-	-	X	-
3	X	-	-	-	-	-	X
4	-	X	-	X	-	-	-
5	-	X	-	-	X	-	-
6	-	X	-	-	-	X	-
7	-	X	-	-	-	-	X
8	-	-	X	X	-	-	-
9	-	-	X	-	X	-	-
10	-	-	X	-	-	X	-
11	-	-	X	-	-	-	X

-312 Number of channels Setting the number of external studio channels

-313 Random generator Tanning start activates the random generator for selecting the music tracks (internal music card only).

\*Presetting is only available with master code

## Index

- 3D sound  
 Description ..... 7  
 Operating functions ..... 7  
 Overview ..... 7  
 Presets ..... 9  
 3D sound (first version), brief description ..... 27  
 3D sound retrofit kit ..... 10, 11, 12, 13, 14, 15
- A**  
 Advantage 350/400, Stereo Sound ..... 21  
 Advantage APS, Stereo Sound ..... 20  
 Affinity, description 3D sound ..... 11  
 Audio bridge 12320 ..... 43
- B**  
 BCD, channel selection method ..... 46  
 Board 12243 ..... 43  
 Board 12244 ..... 41  
 Board 12320 ..... 43  
 Board 12962 ..... 36
- C**  
 Cable set for new models ..... 32  
 Channel selection method ..... 46  
 Checklist presets ..... 58  
 Classic 200/300, Stereo Sound ..... 23  
 Connection options ..... 29  
 Connection options Stereo Sound ..... 38  
 Controls ..... 46
- D**  
 Decimal, channel selection method ..... 46
- E**  
 Esprit, description 3D sound ..... 10  
 Evolution, Stereo Sound ..... 19  
 Excellence, Stereo Sound ..... 19
- F**  
 Formatting an SD card ..... 48
- H**  
 Hardware options Stereo Sound ..... 18
- I**  
 ID3 tag ..... 47  
 Info, brief description ..... 26  
 Input voltage ..... 36, 38  
 Inspiration, description 3D sound ..... 12  
 Internal music (SD card) ..... 31
- L**  
 L-65, description Power Sound ..... 11  
 License-free music ..... 31  
 Lounge, Stereo Sound ..... 24
- M**  
 M-55/M-50, Stereo Sound ..... 19  
 M-60, description Power Sound ..... 11  
 MP3 connection cable ..... 29  
 MP3 files ..... 47  
 MP3 line-in ..... 29  
 Multivision, brief description ..... 27  
 Music SD card ..... 47  
 Music selection ..... 7
- O**  
 Open Sun 1050, description 3D sound ..... 13  
 Open Sun 550, Stereo Sound ..... 20  
 Open Sun Pilot, description 3D sound ..... 14  
 Overview sound systems ..... 5, 6  
 Own music ..... 7
- P**  
 Power Sound, overview ..... 7  
 Prestige, description 3D sound ..... 10  
 Pulse, channel selection method ..... 46
- R**  
 Retrofitting  
   3D sound ..... 7  
   Stereo Sound ..... 16
- S**  
 S-45/S-40, Stereo Sound ..... 22  
 S-55/S-50, description Power Sound ..... 12  
 Salon's music system, connection options 3D sound ..... 32  
 SD card (internal music) ..... 31  
 SD card write protection ..... 49  
 SD card, specification for 3D sound ..... 47  
 Stereo Sound functions ..... 16  
 Stereo Sound, overview ..... 16  
 Studio music channel ..... 7  
 Sun Dash 342 Radius, Stereo Sound ..... 25  
 Sunangel S 46, description 3D sound ..... 11  
 Sunangel S 52, description 3D sound ..... 10  
 Sunrise, description 3D sound ..... 15  
 Supplied with 3D sound ..... 10, 11, 12, 13, 14, 15

**T**

Terminal block, location on unit ..... 39

**V**

V-45, Stereo Sound ..... 25

V-55/V-50, description Power Sound ..... 15

V-55/V-50, Stereo Sound ..... 25

V-60, Stereo Sound ..... 24

Vertical, Stereo Sound ..... 24

Vibra-Sound, brief description ..... 28

Voice Guide, brief description ..... 26

Voice Info, brief description ..... 26

**X**

XL-70, Stereo Sound ..... 19

XXL-95/XL-75, description Power Sound ..... 11





# JK GLOBAL SERVICE

*Ergoline*

*soltron*

SUN|DASH

wellsystem™

## **JK-GLOBAL SERVICE GMBH**

Rottbitzer Straße 69

53604 Bad Honnef

GERMANY

Phone: +49.(0)2224.818-898

Fax: +49.(0)2224.818-205

Internet: [www.jk-globalservice.de](http://www.jk-globalservice.de)

E-Mail: [info@jk-globalservice.de](mailto:info@jk-globalservice.de)

1004450